

SAMPLING VALVE

取样阀



应用

主要用于罐设备或管道里面的物料样品采集,也可按照在罐设备或管道的最低点用来排泄残留液。

APPLICATION

Mainly used in tank equipment or pipeline samples of the material inside the collection, but also in accordance with the lowest point of the tank equipment or pipes used to excrete residual liquid.

技术参数

接口形式:焊接,卡箍,螺纹
 最大压力:+10bar +145psi
 适用温度:-10°C至+140°C
 阀体材质:SS304 SS316L
 密封材质:SI,EPDM

TECHNICAL PARAMETERS

Interface form: welding, clamps, threads
 Greatest pressure: +10bar +145psi
 proper temperature: -10°C to +140°C
 Body material: SS304 SS316L
 Sealing material: SI, EPDM

工作原理

SQK系列无菌取样阀采用橡胶密封,分为手柄快开型,手轮微调型、气动型和手气一体型四种开启方式。带弹簧自动复位功能,抬起手柄或扭转手轮同步提升阀芯,使隔膜阀头脱离密封口开启阀门取样;放下手柄和反方向旋转手轮处于空置状态时弹簧作用自动关闭阀门。

WORKING PRINCIPLE

SQK series of sterile sampling valve with rubber seal, divided into the handle quick-opening type, hand wheel fine-tuning type, pneumatic and hand-gas integrated four open mode. With spring automatic reset function, lift the handle or turn the hand wheel synchronous poppet, so that the diaphragm valve head from the sealing port to open the valve sampling; put down the handle and the opposite direction of rotation of the hand wheel is in a vacant state, the spring automatically close the valve.

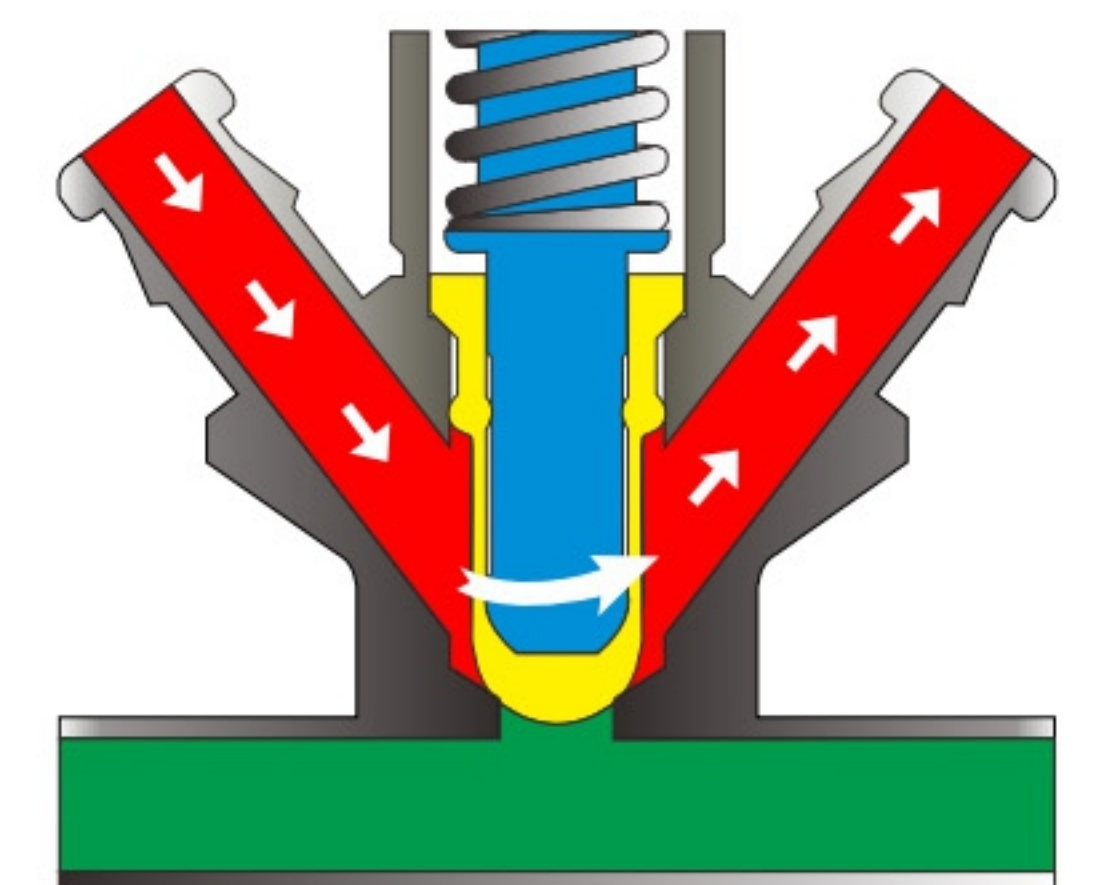
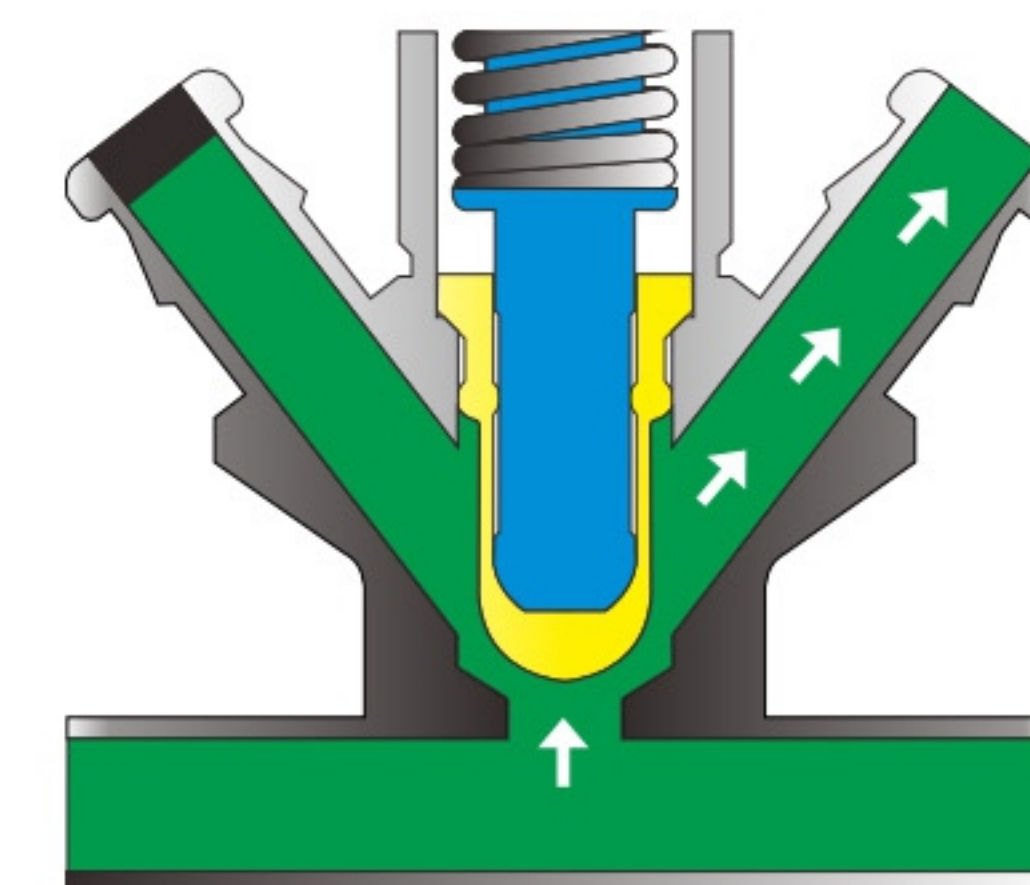

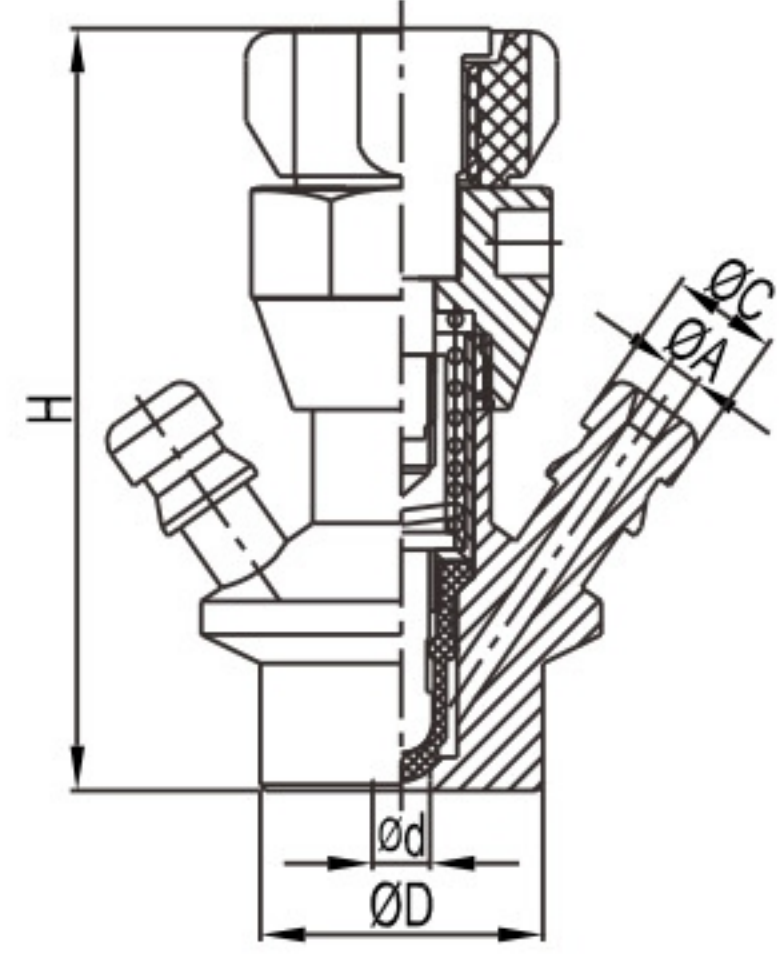

焊接型微生物无菌取样阀

Welding type microbial sterile sampling valve

Size	d	D	A	C	H
DN6	4	28	3	9.5	68
DN10	8	28	7	14	93

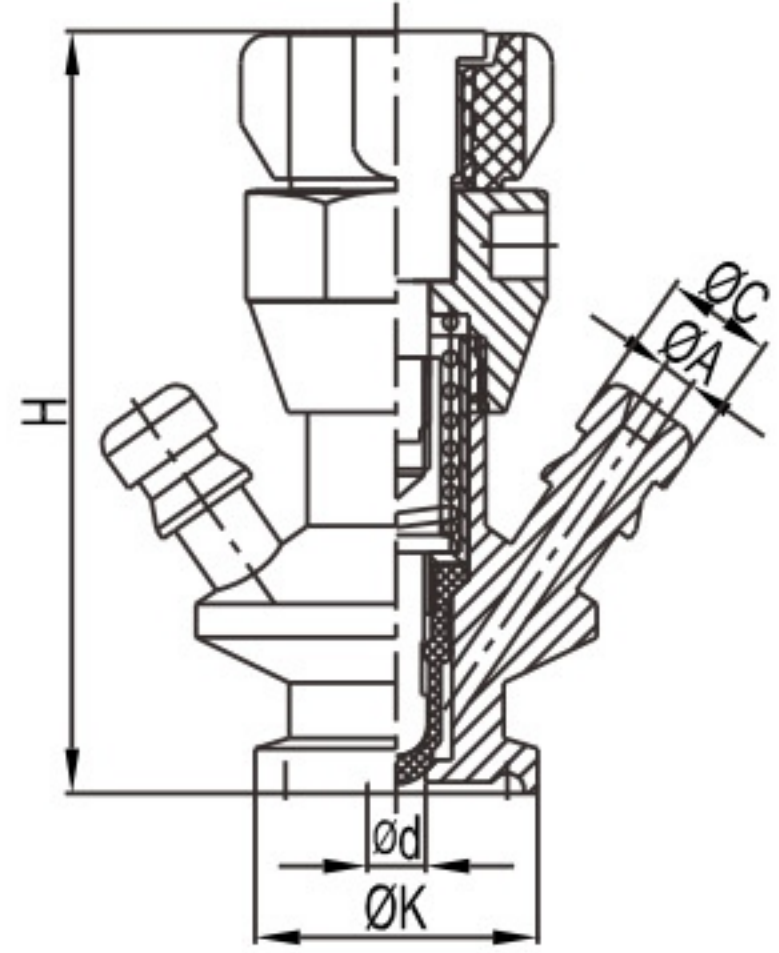

卡箍型微生物无菌取样阀

Clamp type microbial sterile sampling valve

Size	d	K	A	C	H
DN6	4	25.2	3	9.5	68
DN10	8	50.5	7.2	14	93

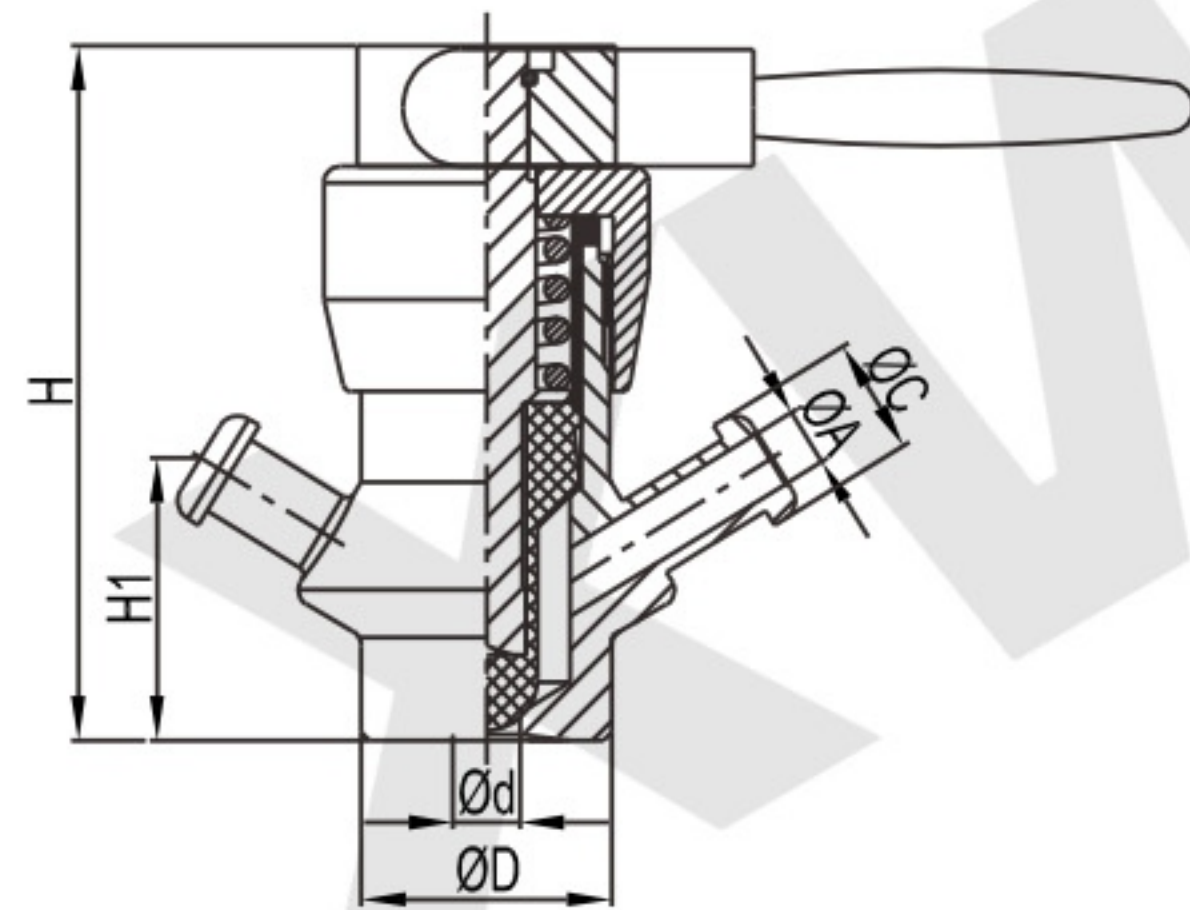

焊接型快开无菌取样阀

Weld type quick open sterile sampling valve

Size	d	D	A	C	H1	H
DN10	8	30	7.2	14	34	84

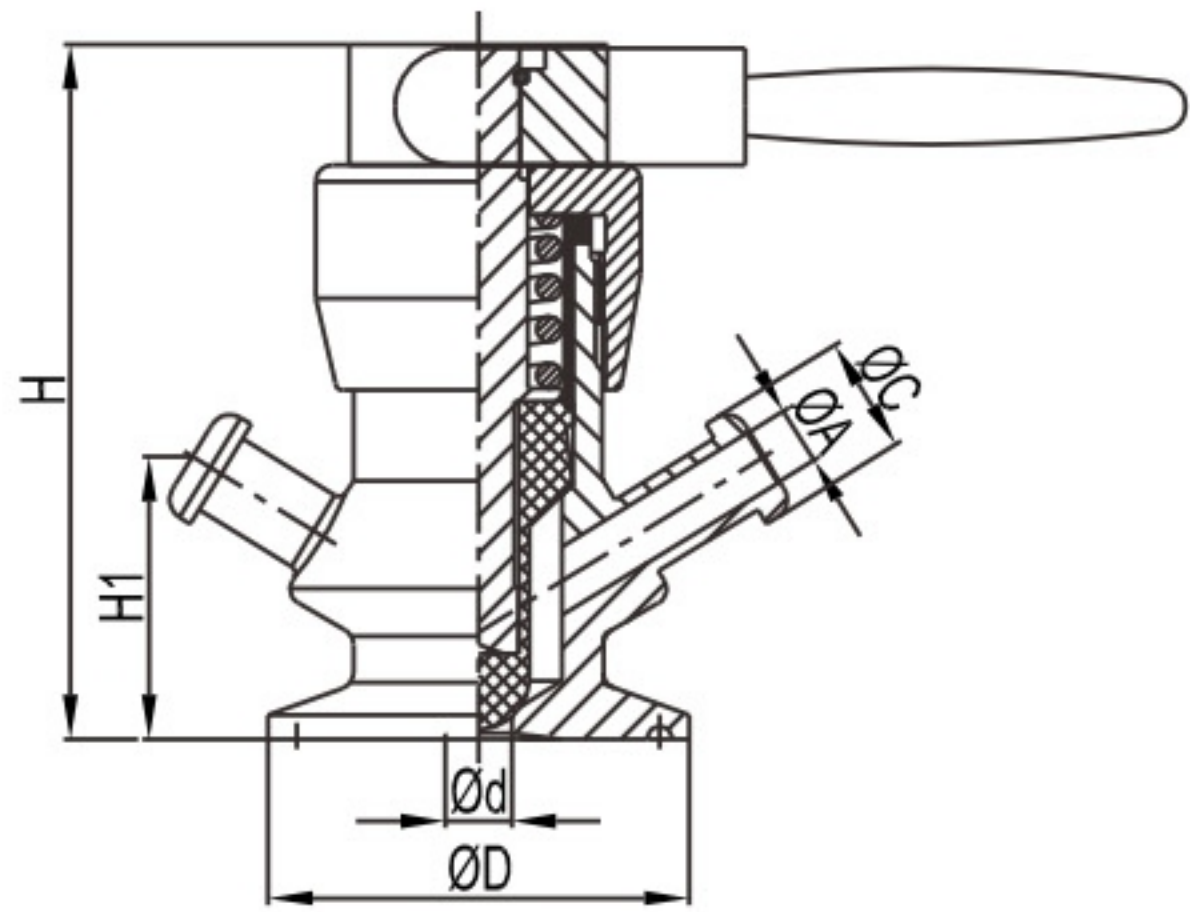

卡箍型快开无菌取样阀

Clamp type quick open sterile sampling valve

Size	d	K	A	C	H1	H
DN10	8	25.2/50.5	7.2	14	34	84

气动无菌取样阀

Pneumatic aseptic sampling valve

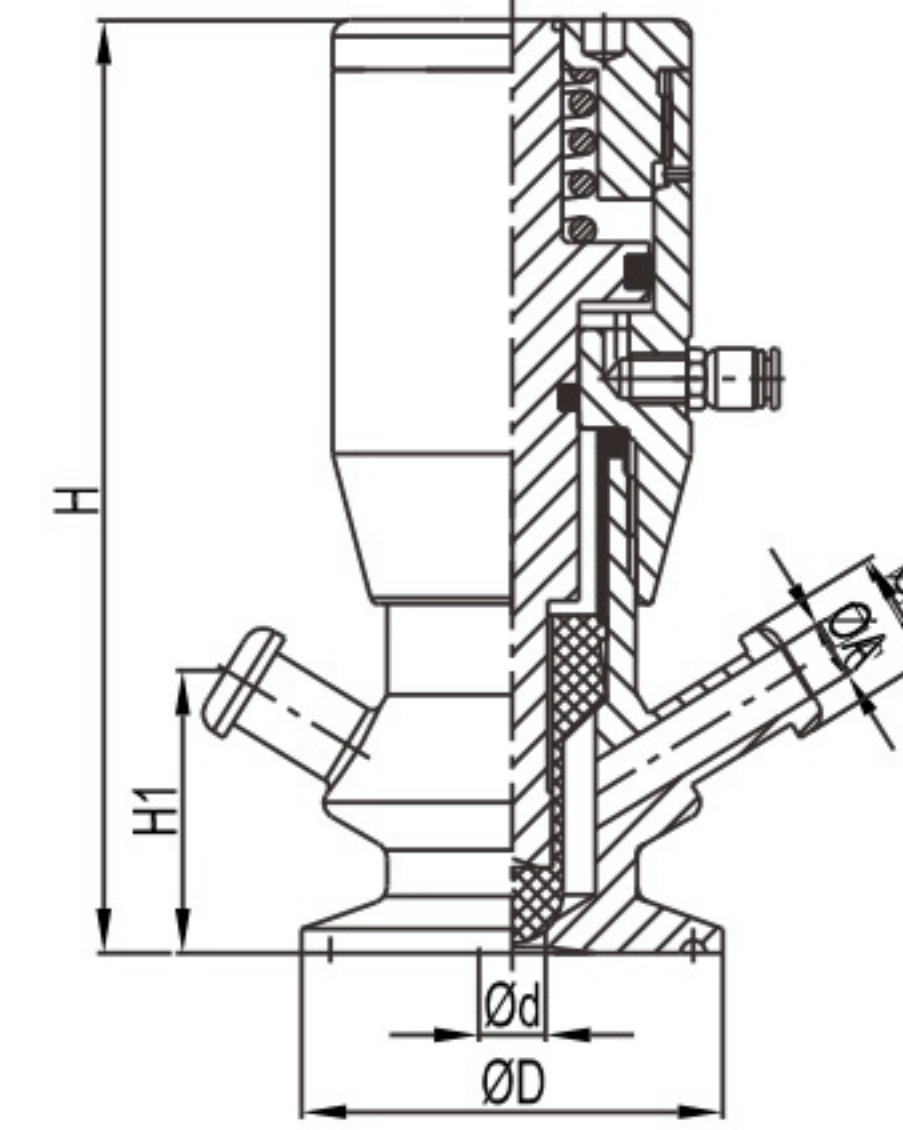

手/气一体无菌取样阀

Hand / gas integrated sterile sampling valve

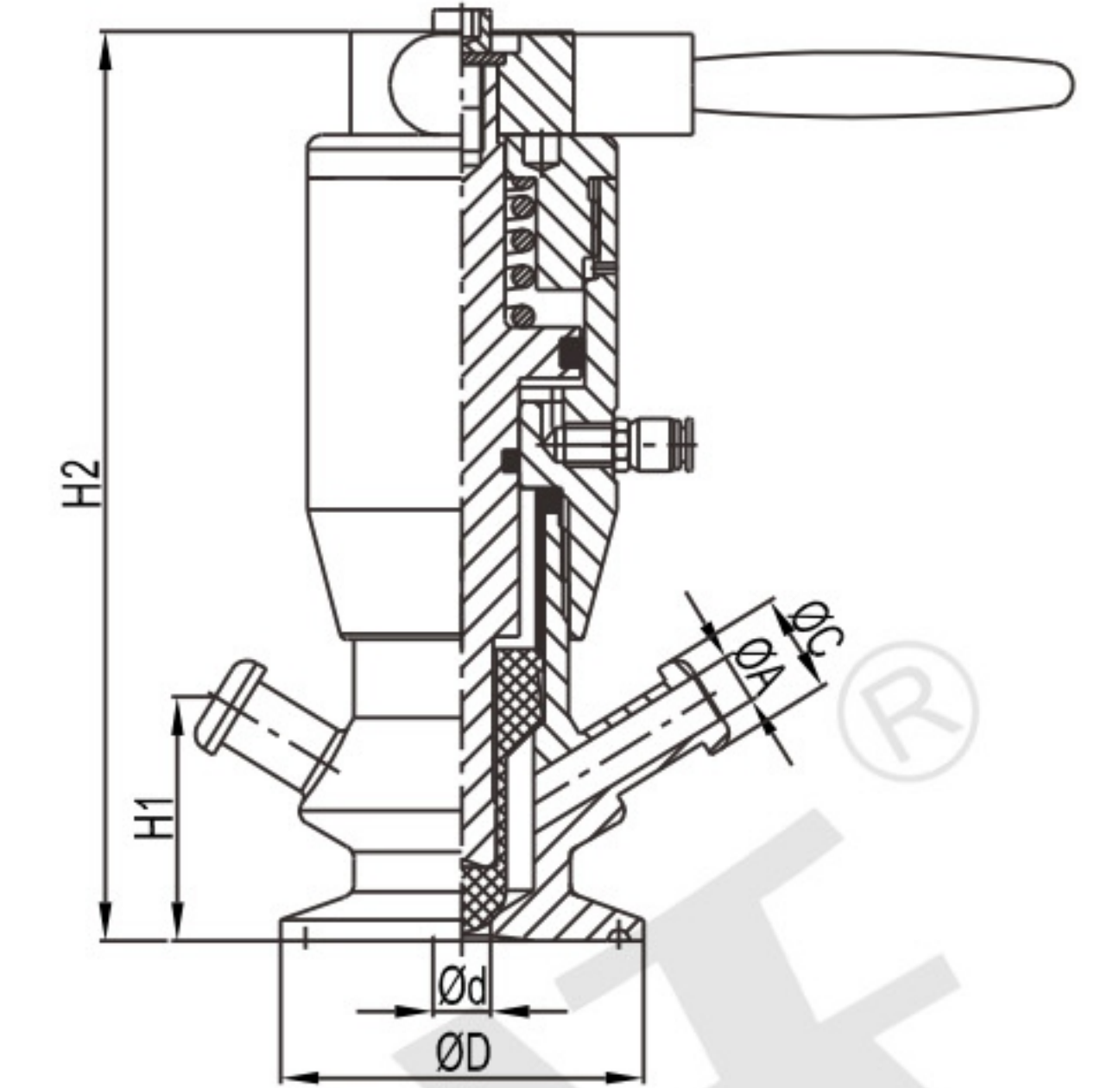

Size	d	K	A	C	H1	H2	H
DN10	8	25.2/50.5	7.2	14	34	128	84

啤酒取样阀

Beer sampling valve

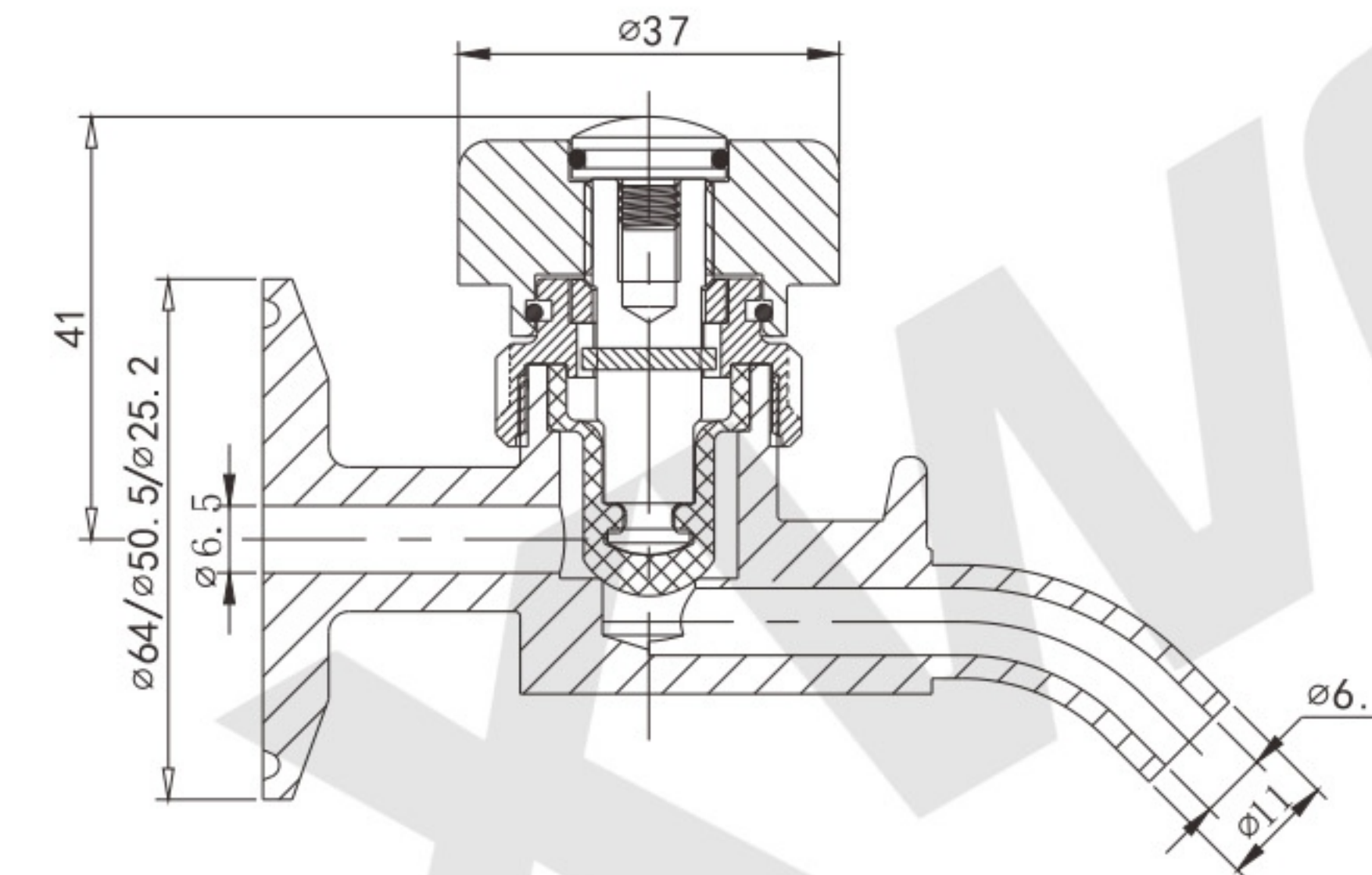

可配6mm胶管接头

Can be equipped with 6mm hose connector

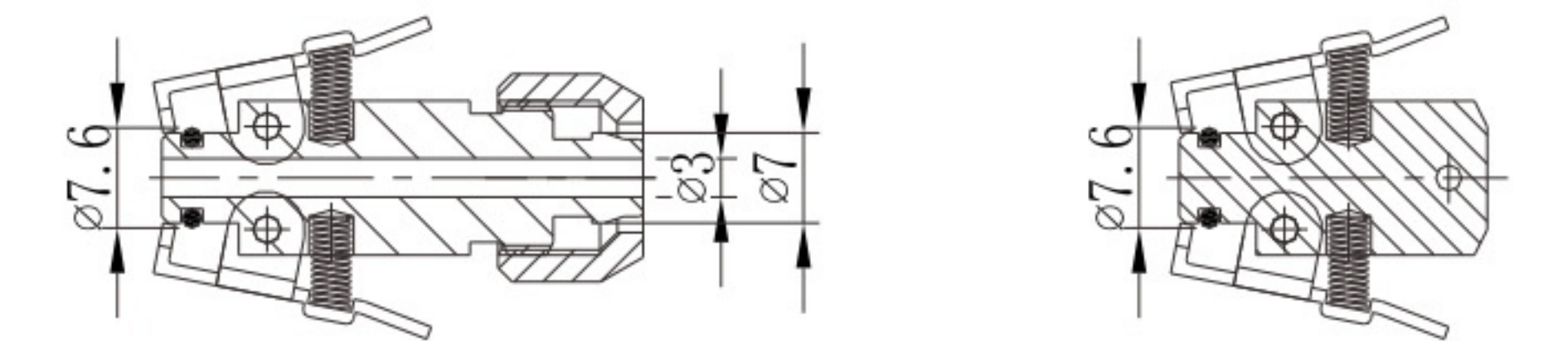

多种接口样式

HA variety of interface styles

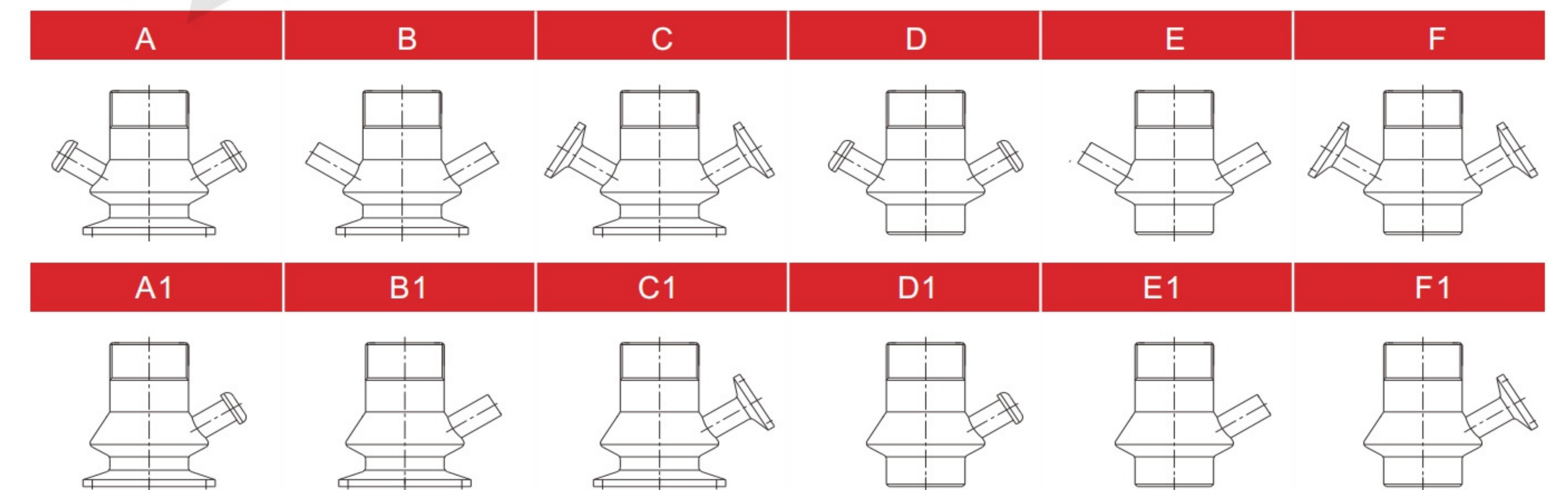

无菌取样阀特性

ASEPTIC SAMPLING VALVE FEATURES

无菌取样阀采用PTFE隔膜密封，通过膜片的伸缩来开启和关闭阀门。该系列分为不锈钢手柄快开型，塑料手柄快开型，手轮微调型、气动型和手气一体型五种开启形式。手动快开型和气动型带弹簧自动复位功能，可适应多种实际工况需求。

The sqm series sterile sampling valves are sealed with ptfе septum to open and close the valve Through telescoping of the diaphragm. The series is divided into stainless steel handle quick opening type Plastic handle quick opening type, hand wheel fine-tuning type, pneumatic type and hand gas one of five Open form. Manual quick-open type and pneumatic automatic reset function with spring, can adapt to a variety Of the actual working conditions.



开启形式 Open form



技术参数

接口形式:焊接,卡箍,无菌法兰
 手动型最大压力:+10bar(145psi)
 弹簧复位型最大压力:+6bar+145psi
 适用温度:-10°C至+140°C
 阀体材质:SS304 SS316L
 密封材质:聚四氟乙烯

TECHNICAL PARAMETERS

Interface form:welding, clamps, sterile flanges
 Greatest pressure: +10bar(145psi)
 Spring reset type maximum pressure: +6bar(145psi)
 proper temperature:-10°C to +140°C
 Body material:SS304 SS316L
 Sealing material:PTFE

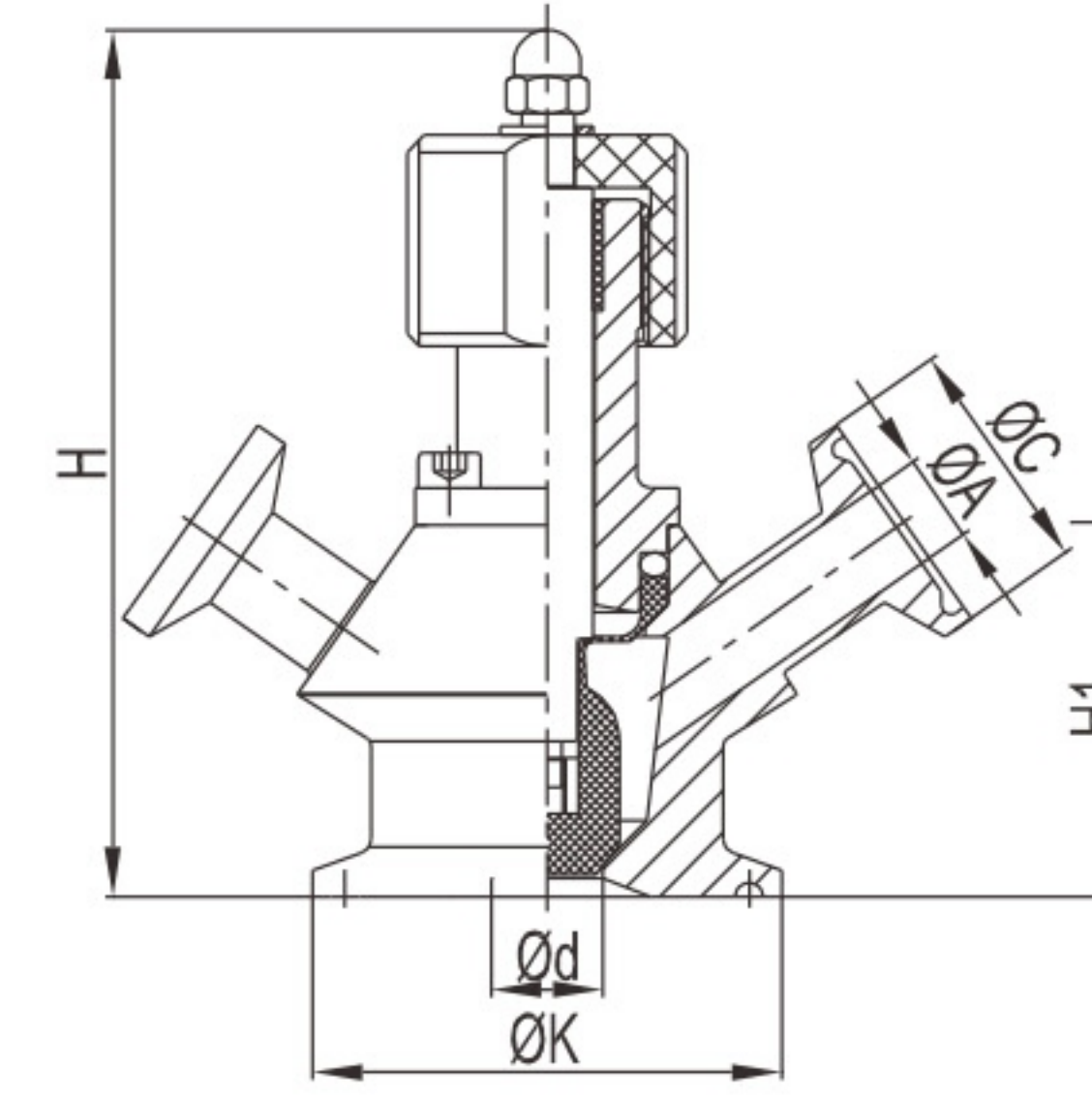

卡箍型无菌取样阀

Clamped Aseptic Sample Valve

Size	d	K	A	C	H1	H
DN6	6	25.2	5	25.2	37.5	85
DN8	8	25.2/50.5	5	25.2	44.5	85
DN10	9.5	25.2/50.5	9.5	25.2	44.5	85
DN15	12	50.5	9.5	25.2	41.5	93

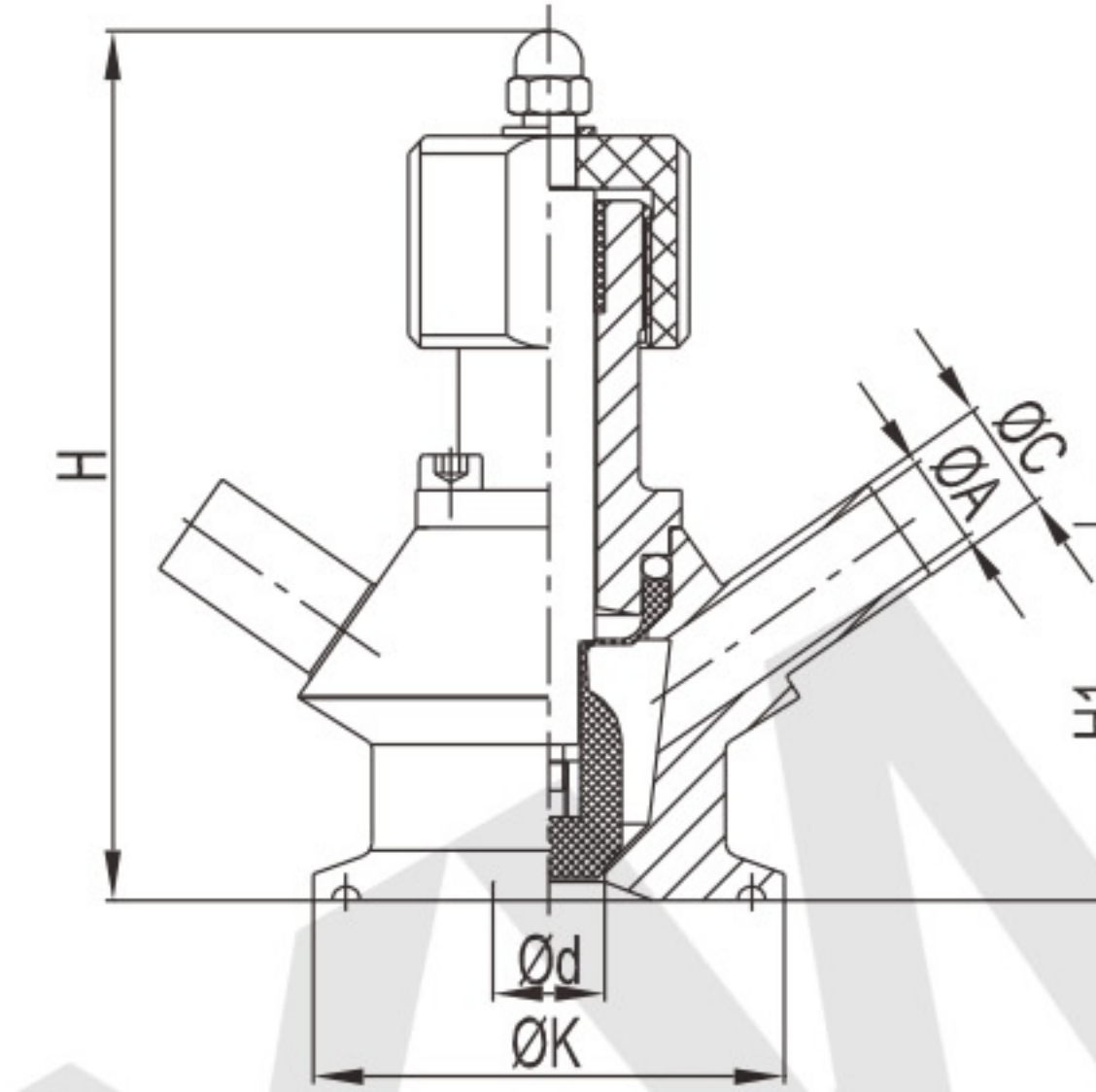

卡箍型无菌取样阀

Clamped Aseptic Sample Valve

Size	d	K	A	C	H1	H
DN6	6	25.2	5	8	37.5	85
DN8	8	25.2/50.5	5	8	44.5	85
DN10	9.5	25.2/50.5	9.5	12.7	44.5	85
DN15	12	50.5	9.5	12.7	41.5	93

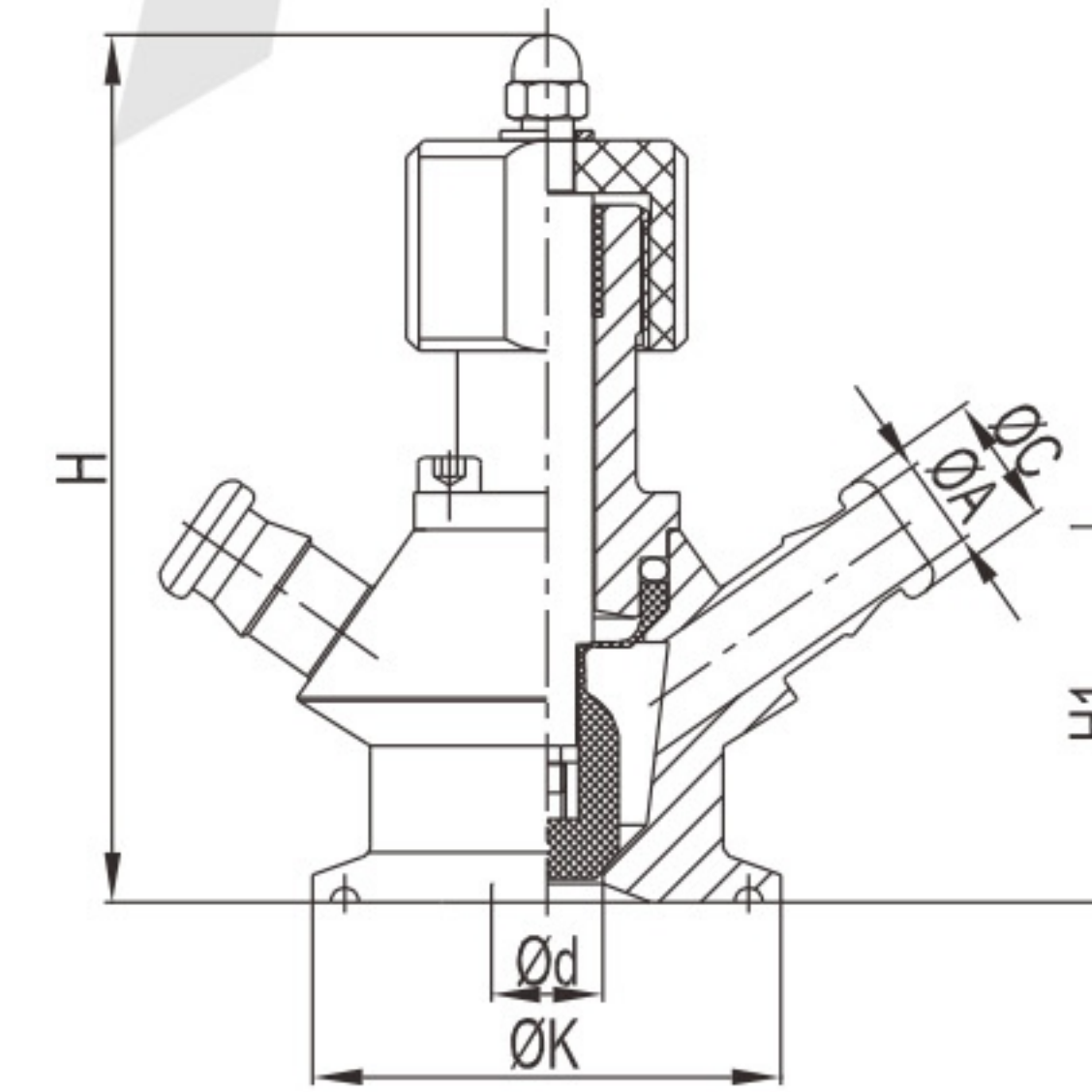

卡箍型无菌取样阀

Clamped Aseptic Sample Valve

Size	d	K	A	C	H1	H
DN6	6	25.2	5	9.5	37.5	85
DN8	8	25.2/50.5	5	9.5	44.5	85
DN10	9.5	25.2/50.5	9.5	14	44.5	85
DN15	12	50.5	9.5	14	41.5	93

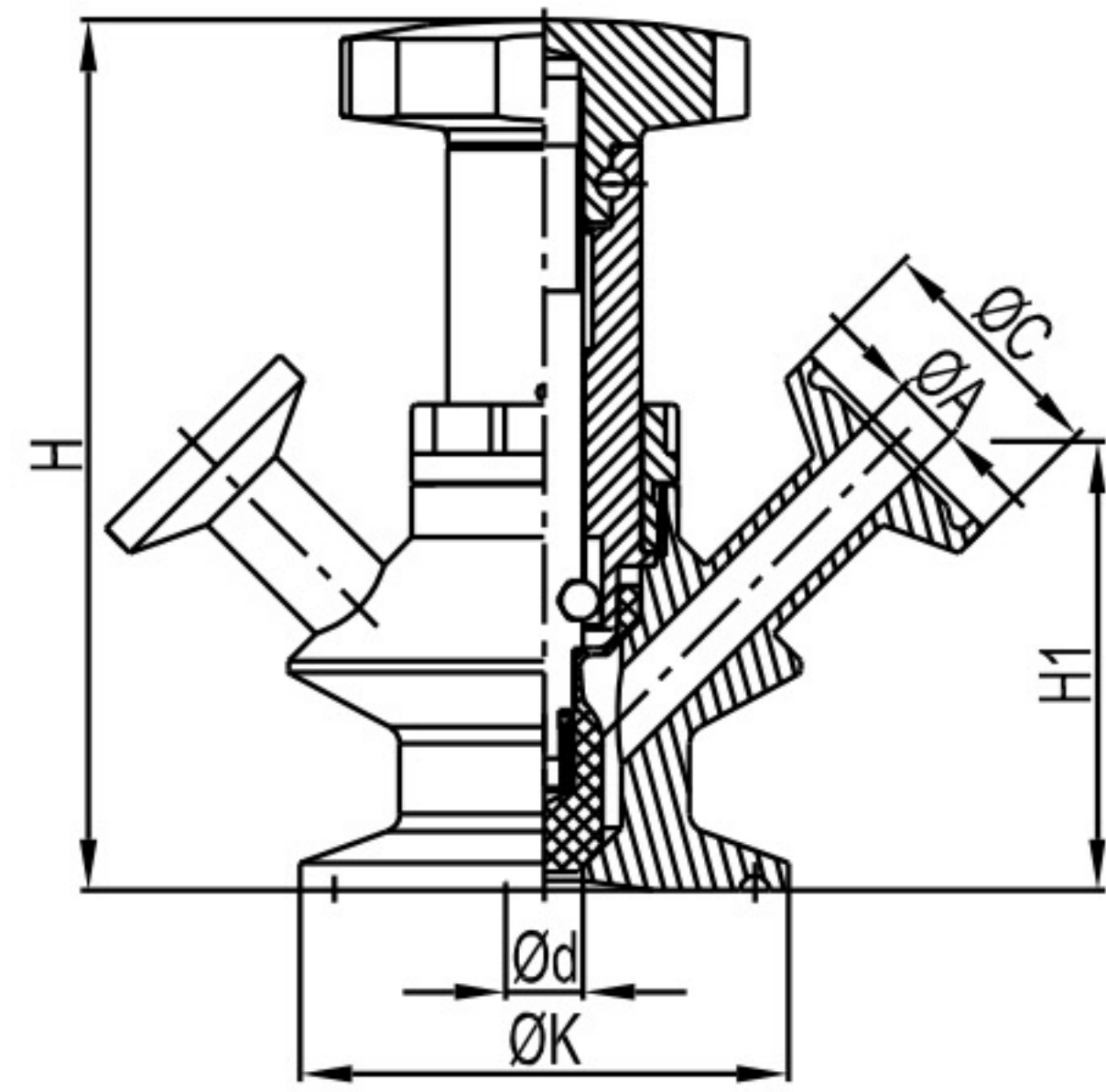

卡箍型无菌取样阀

Clamped Aseptic Sample Valve

Size	d	K	A	C	H1	H
DN8	8	25.2/50.5	7.2	25.2	46	90
DN10	9.5	25.2/50.5	7.2	25.2	46	90
DN15	12	50.5	9.5	25.2	44	94.5

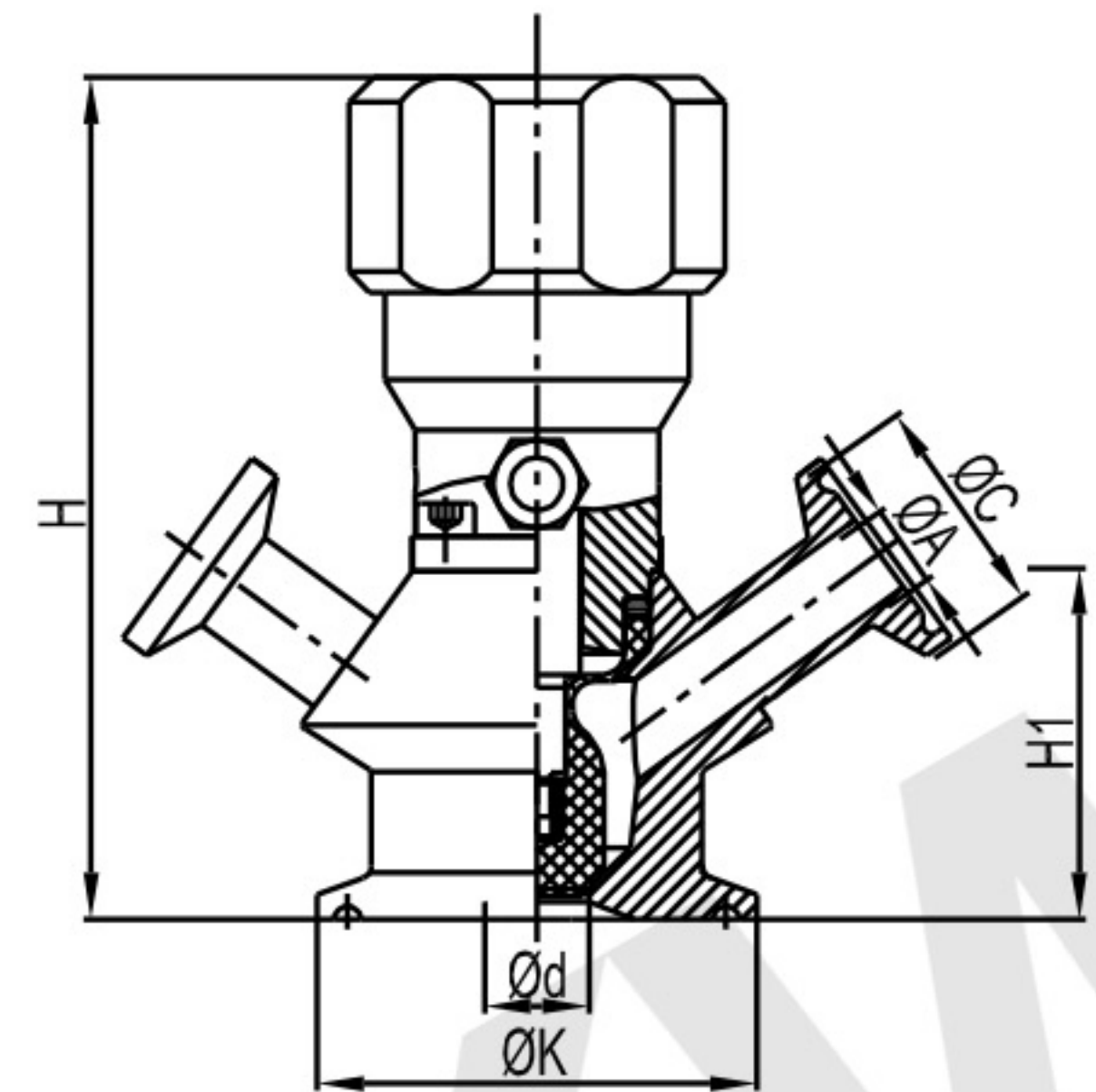

气动无菌取样阀

Pneumatic aseptic sampling valve

Size	d	K	A	C	H1	H
DN6	6	25.2	5	25.2	37.5	91
DN8	8	25.2/50.5	5	25.2	44.5	92
DN10	9.5	25.2/50.5	9.5	25.2	44.5	92
DN15	12	50.5	9.5	25.2	41.5	98

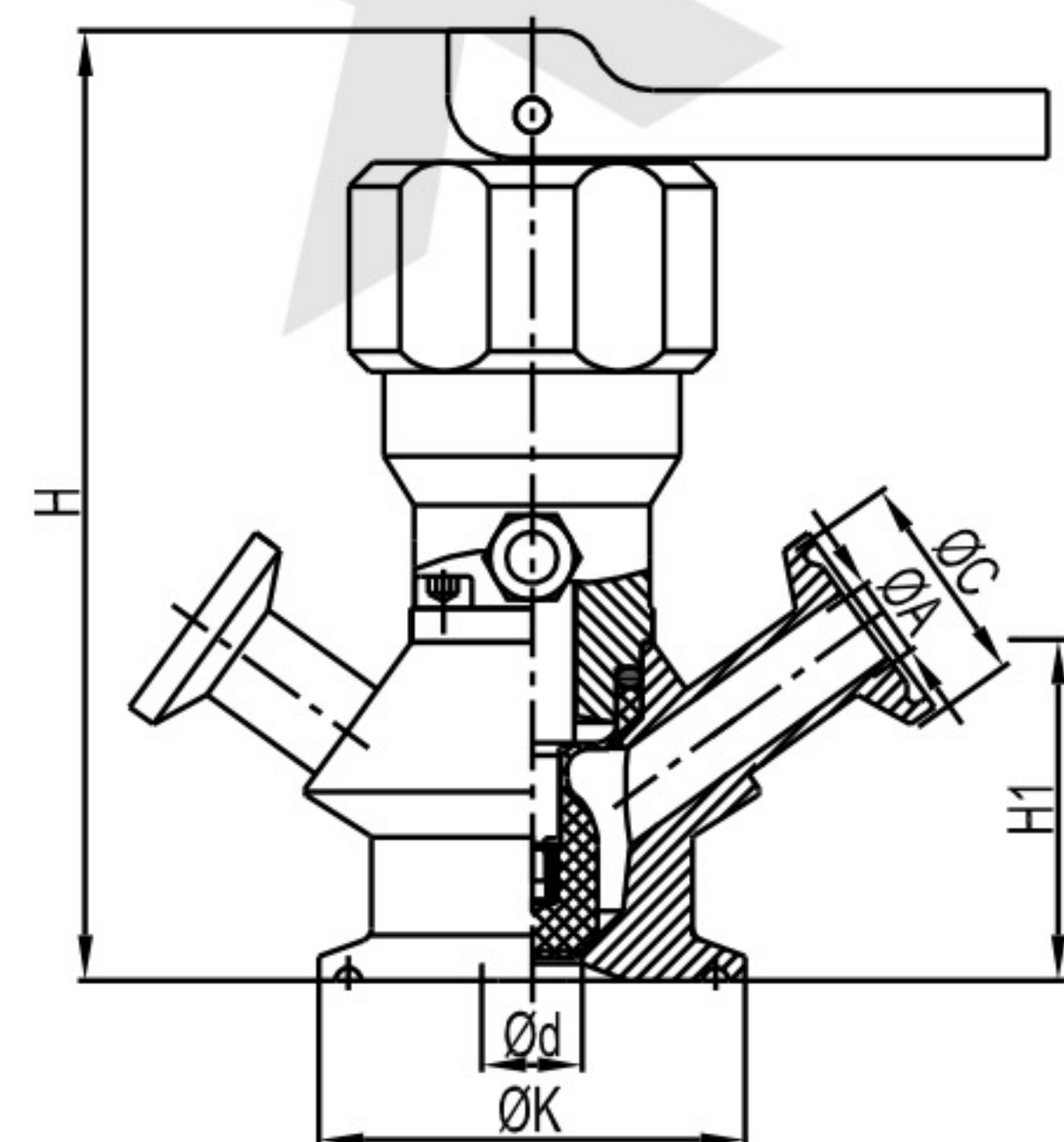

手/气一体无菌取样阀

Hand / gas integrated sterile sampling valve

Size	d	K	A	C	H1	H
DN6	6	25.2	5	25.2	37.5	105
DN8	8	25.2/50.5	5	25.2	44.5	106
DN10	9.5	25.2/50.5	9.5	25.2	44.5	106
DN15	12	50.5	9.5	25.2	41.5	112

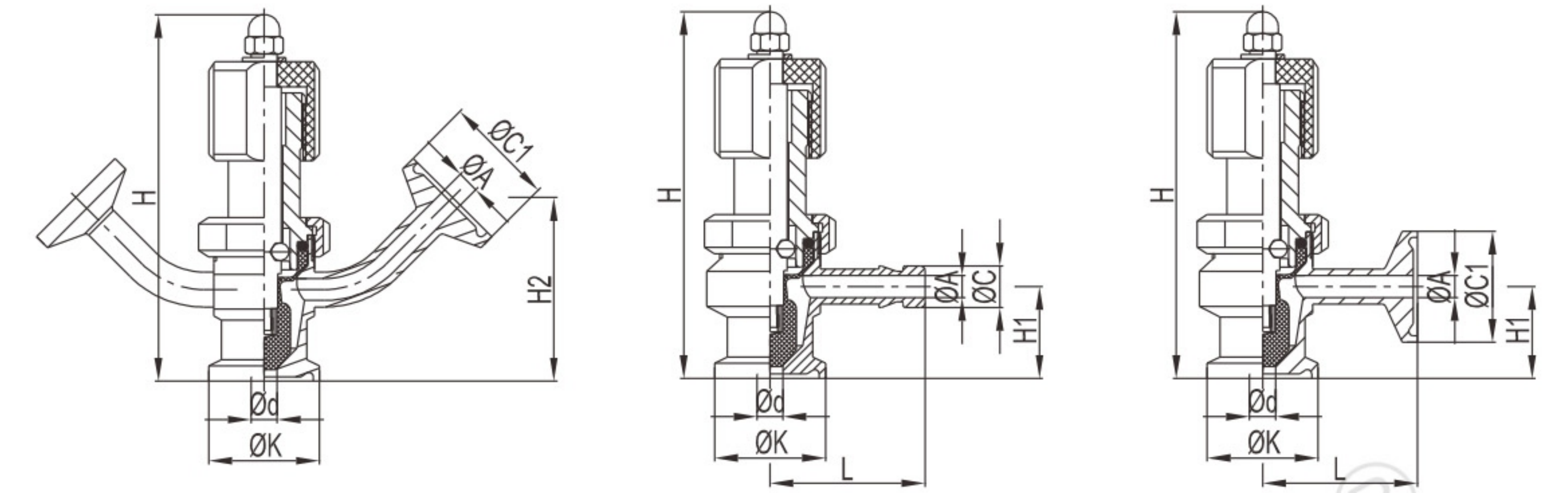

卡箍型无菌取样阀

Clamped Aseptic Sample Valve

Size	d	K	A	C	C1	L	H1	H2	H
Dn6	6	25.2	5	9.5	25.2	35	21	42	84

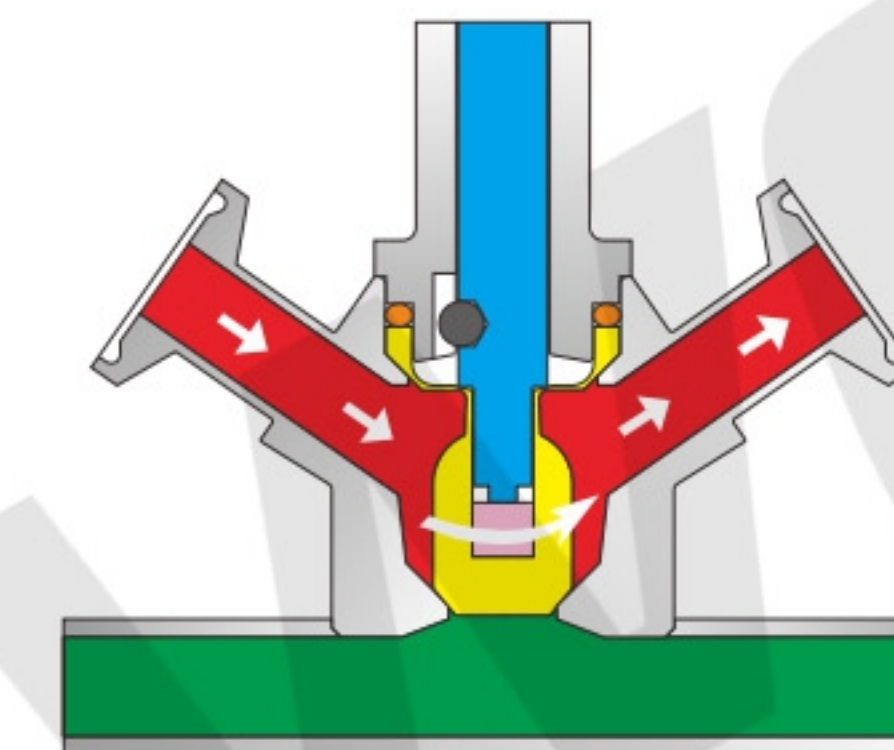

灭菌流向示意图
Sterilization flow diagram

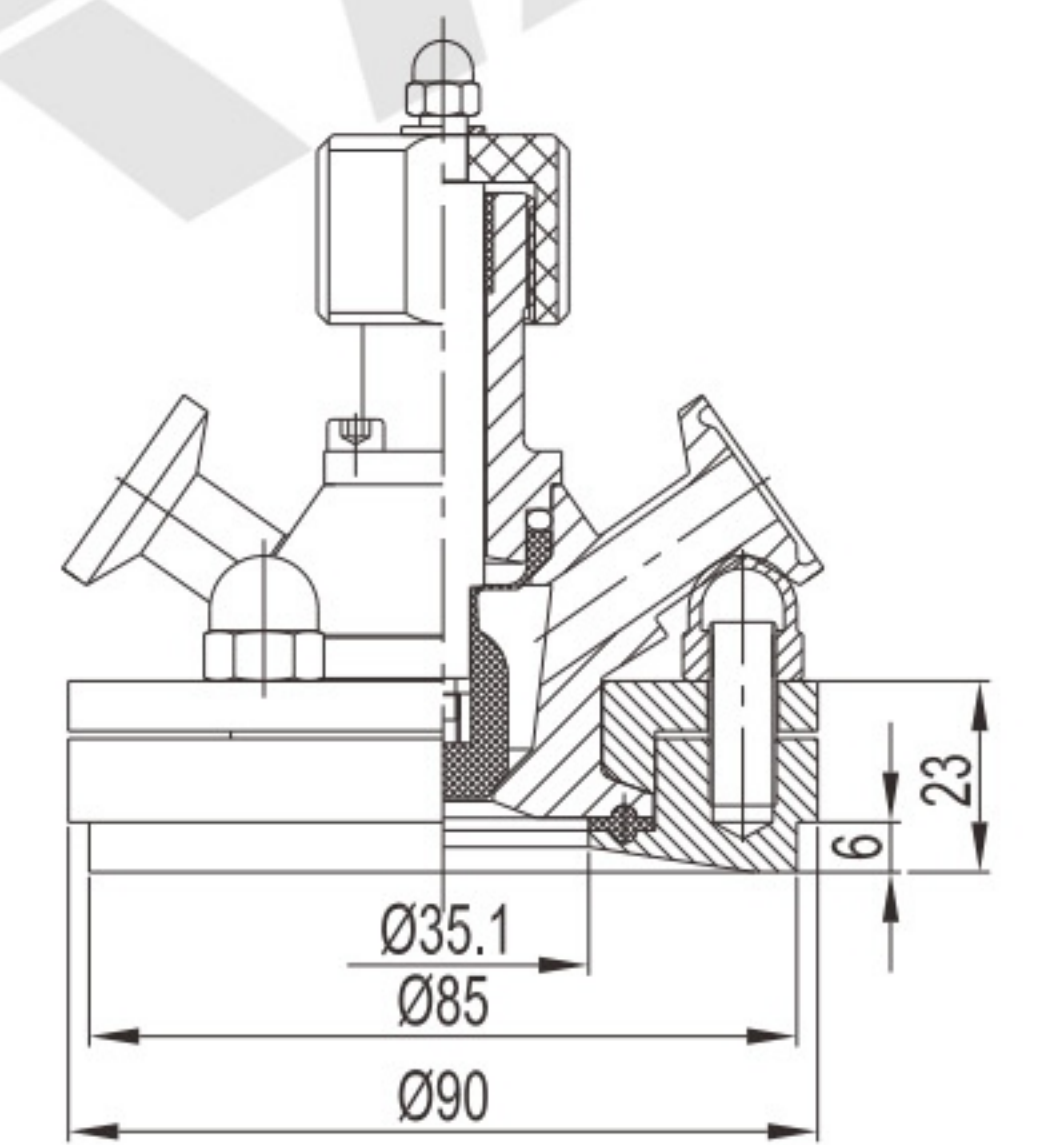

无菌取样阀与无菌法兰
Sterile sampling valves and sterile flanges

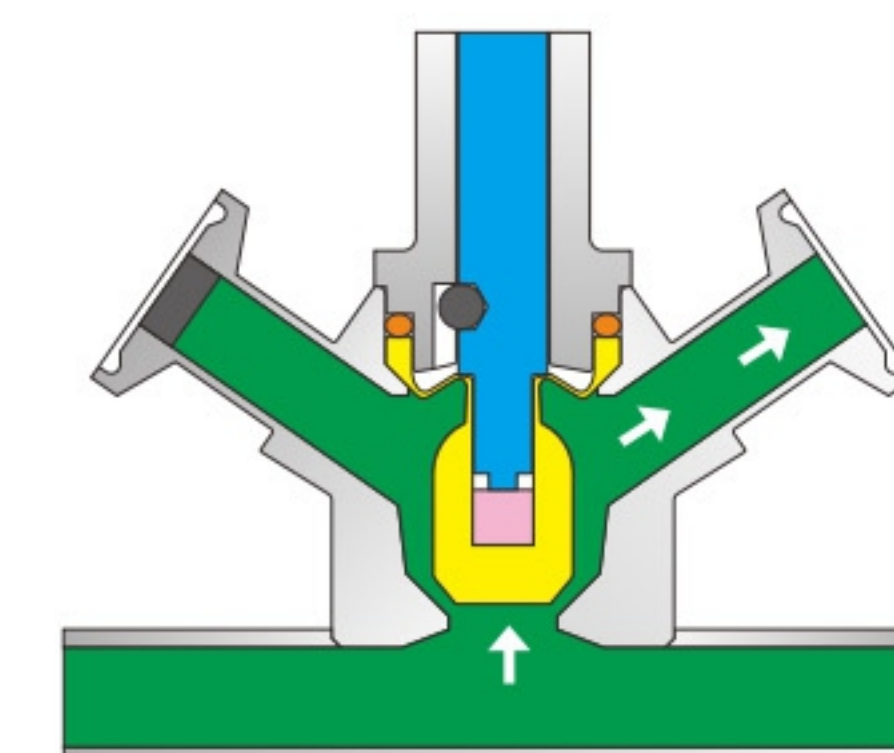

取样流向示意图
Sample flow diagram

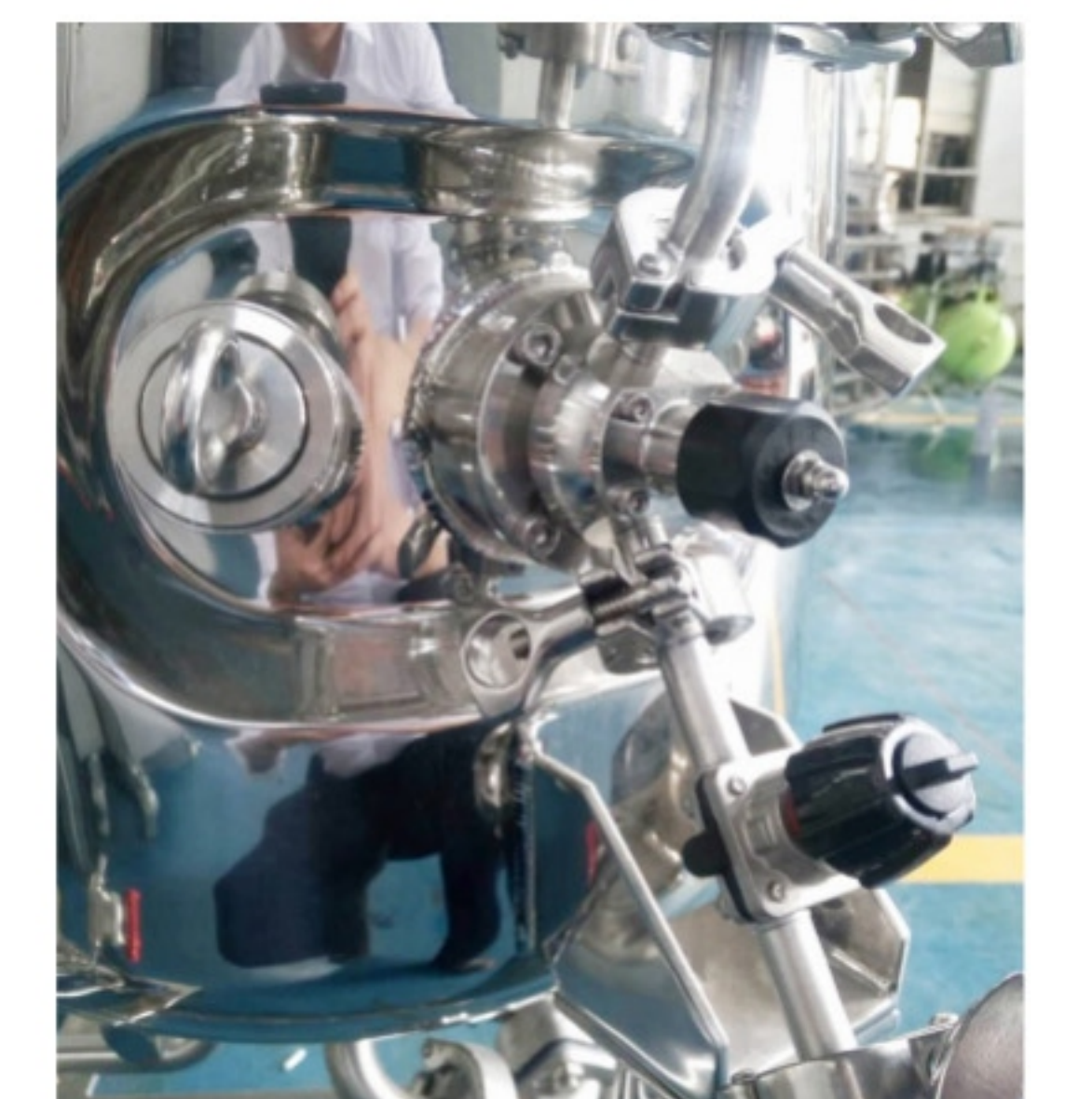

卫生取样阀

SANITARY SAMPLING VALVE



椭圆形手轮
Oval hand wheel



圆形手轮
Round the handwheel



硅橡胶阀头
Silicone rubber valve head



PTFE 阀头
PTFE valve head



斜出口
Oblique export



直出口
export of straight

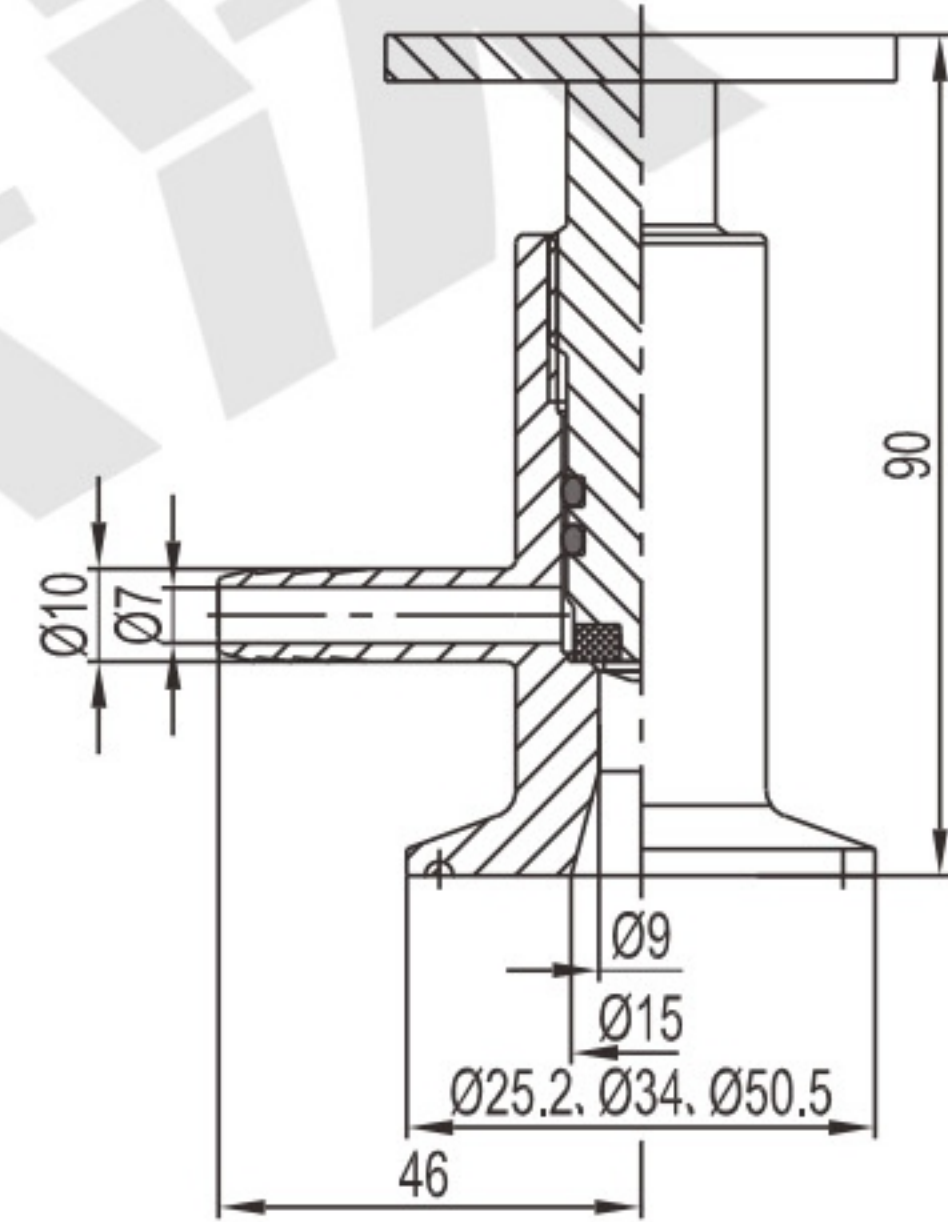

卡箍型取样阀
Clamp type sampling valve

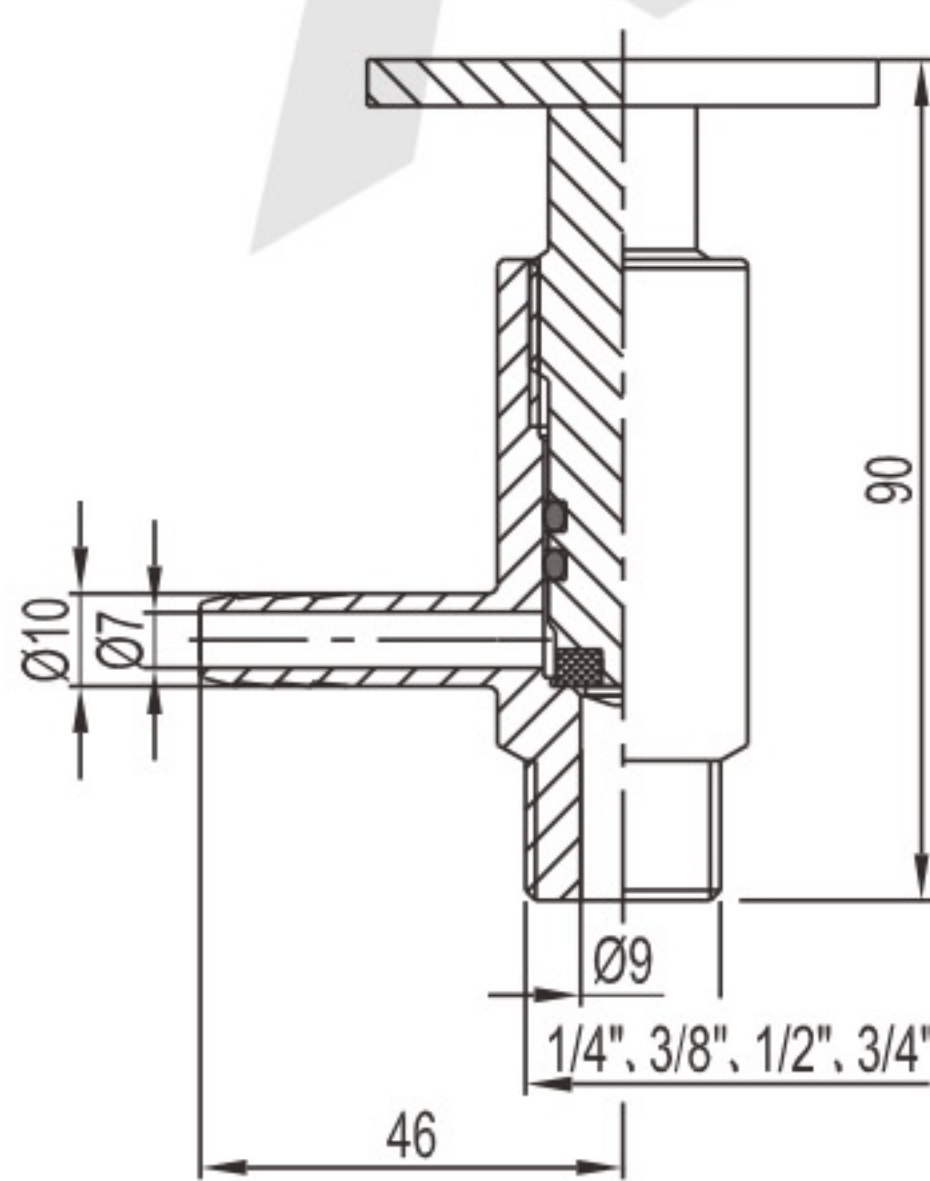

外螺纹取样阀
Male thread sampling valve

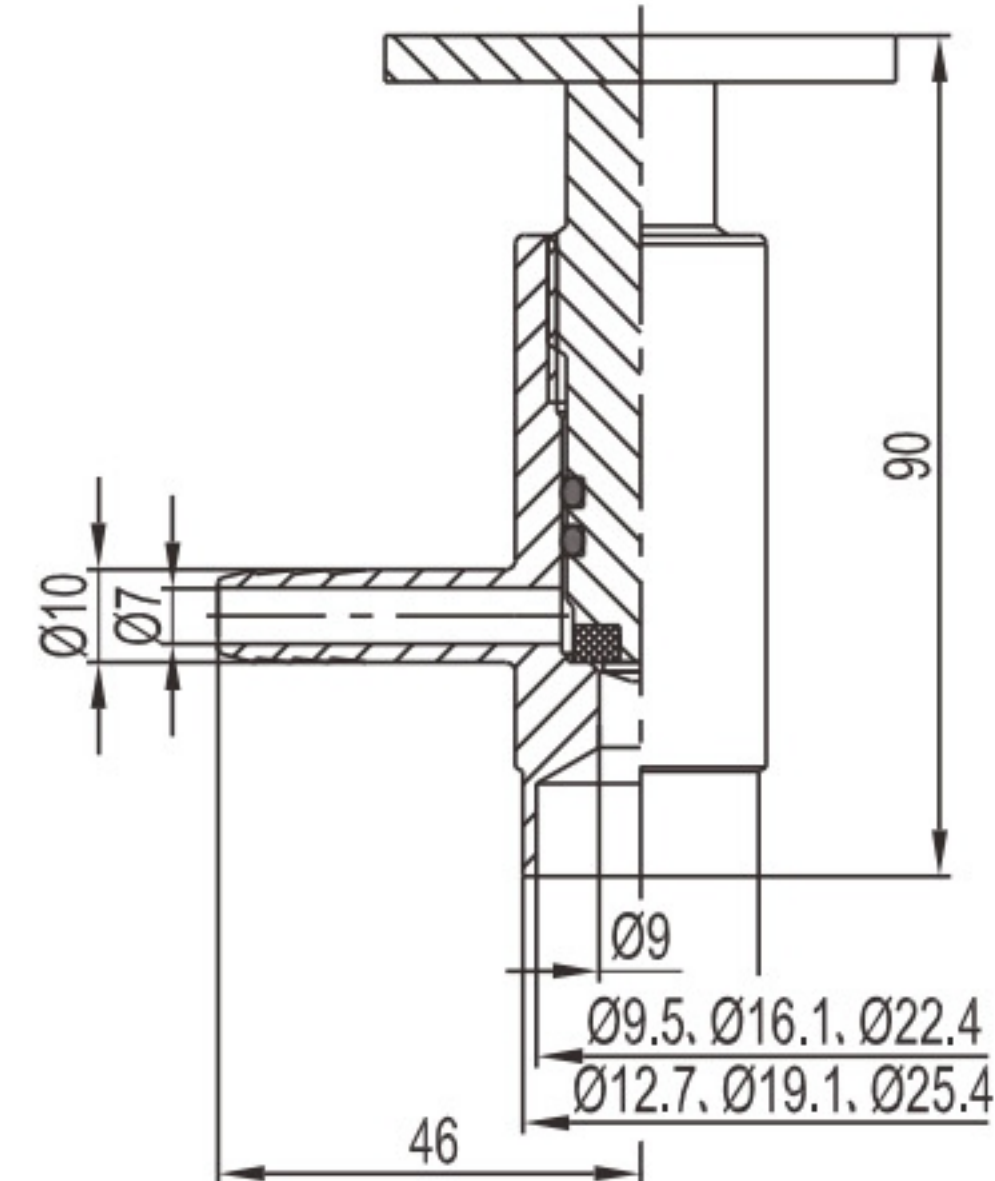

焊接型取样阀
Welded sampling valve

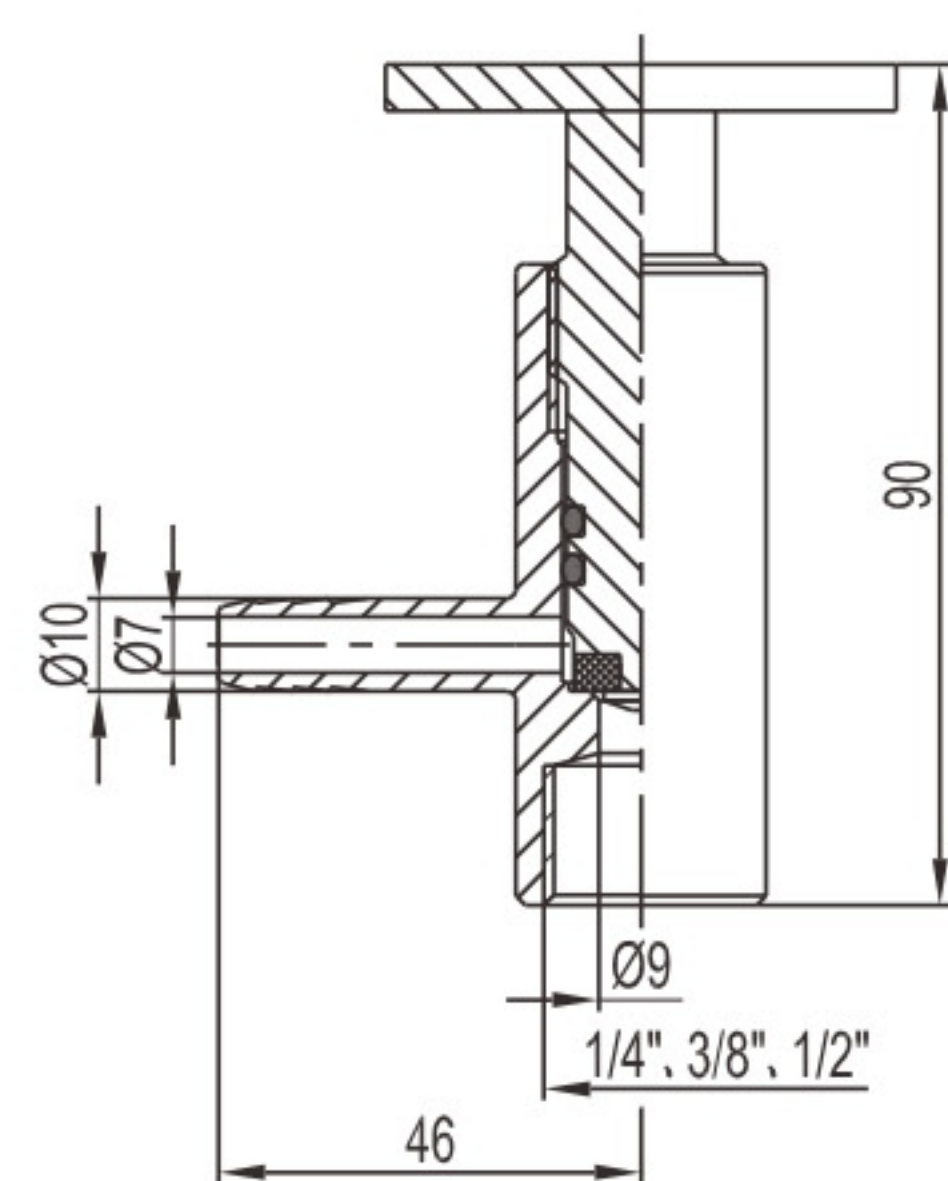

内螺纹取样阀
Internal thread sampling valve

恒压阀

CONSTANT PRESSURE VALVE

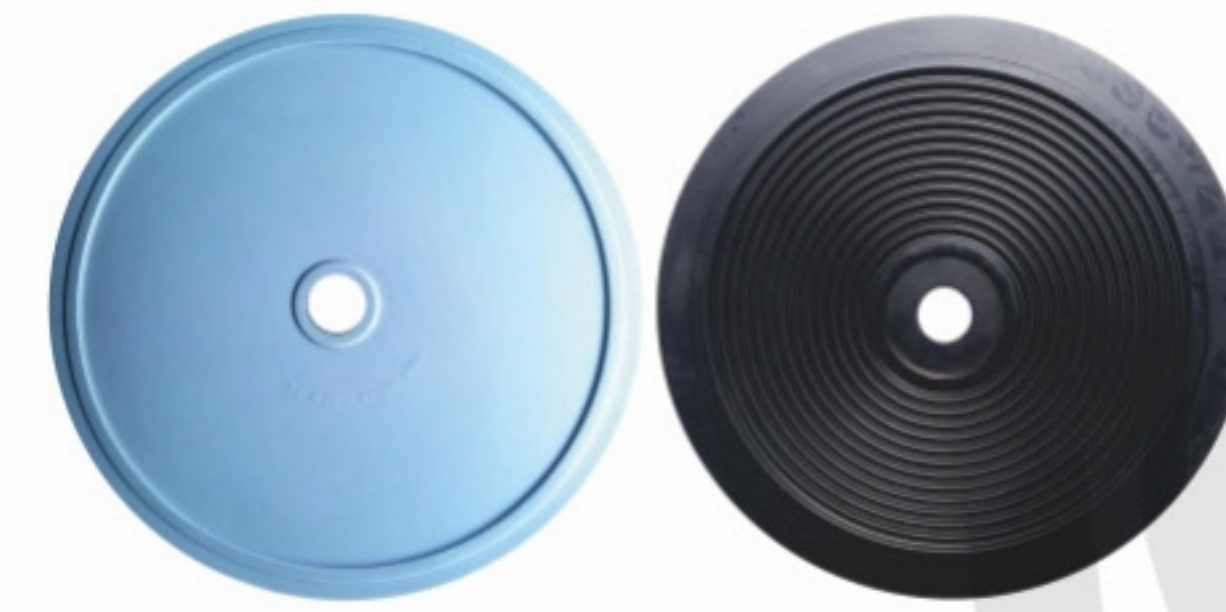

阀芯密封

Valve core sealing

- 上膜片: NBR
Upper diaphragm: NBR
- 下膜片: EPDM+PTFE
Lower diaphragm: EPDM+PTFE

技术参数

Technical parameters

- 气管连接: R1/4"(BSP)
Tracheal connection: R1/4"(BSP)
- 产品压力 ≤ 1.0Mpa
Product pressure ≤ 1.0Mpa
- 气源压力 ≤ 0.8Mpa
Air pressure ≤ 0.8Mpa
- 温度范围: -10°C 至 +140°C
Temperature range: -10°C to +140°C

应用 APPLICATION

CPMI-2(恒压调节入口) 可在阀的入口处使生产过程流水线保持恒压。典型应用在分离器、热交换器或溢流阀后面。CPMO-2(恒压阀调节出口) 可在阀的出口处使生产过程的流水线保持恒压。典型应用在填充或灌装机前面。

The CPMI-2 (constant pressure regulating inlet) maintains constant pressure on the production line at the valve inlet. Typically used behind separators, heat exchangers or relief valves. CPMO-2 (constant pressure valve regulating outlet) can maintain constant pressure in the pipeline of the production process at the outlet of the valve. Typically used in front of a filling or filling machine.

工作原理 WORKING PRINCIPLE

阀门可通过压缩空气进行远程控制。隔膜/阀塞系统会对产品压力的任何变化立即做出反应并改变位置，使预设的压力得以保持。

The valve can be remotely controlled by compressed air. The diaphragm/plug system responds immediately to any change in product pressure and changes position to maintain the preset pressure.

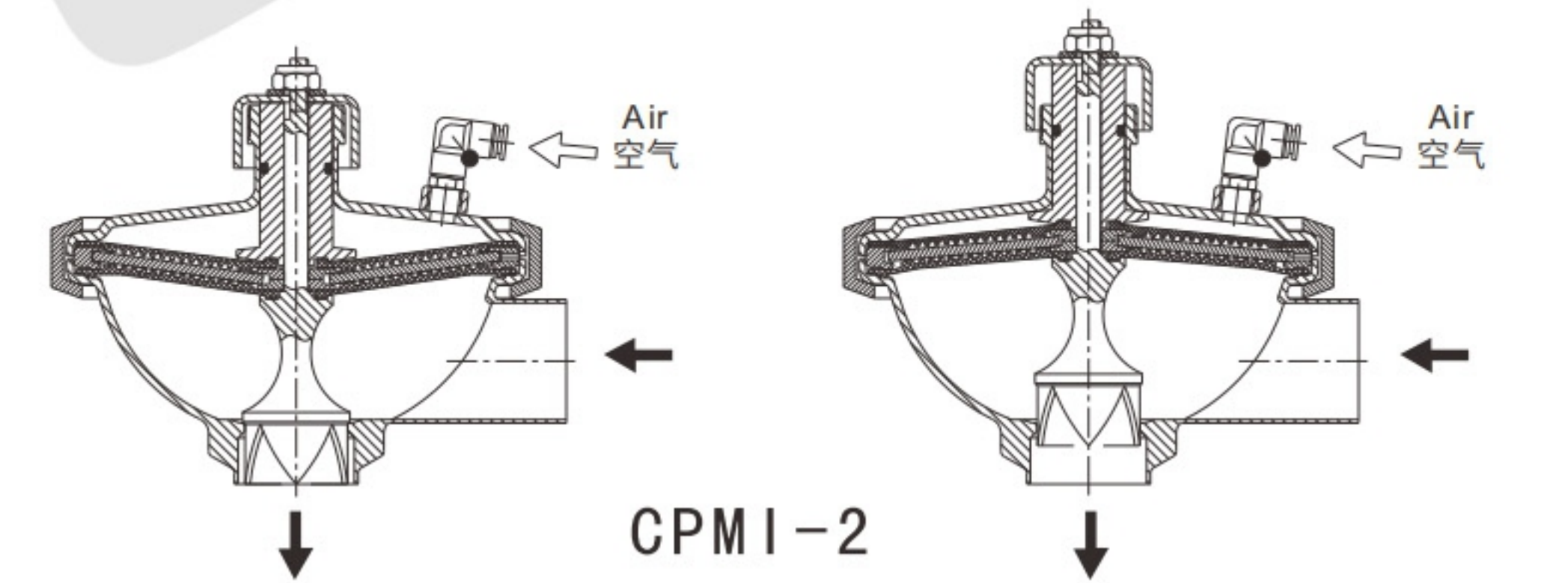

增加产品压力时阀门打开
Valve opens when increasing product pressure

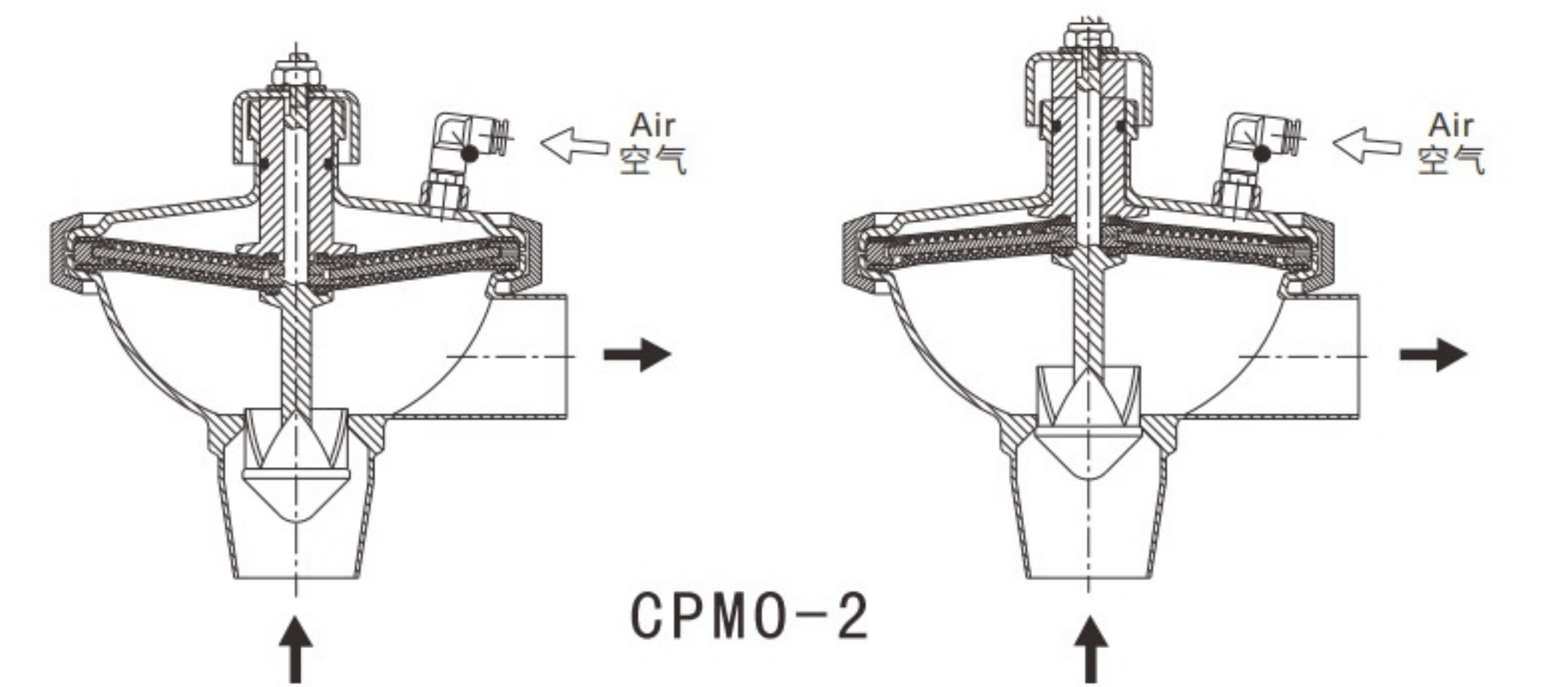

增加产品压力时阀门关闭
Valve closes when product pressure is increased

注意! ATTENTION!

图表的适用说明: 介质: 水 (20°C);
管道与阀门中的流速勿超过5米/秒。

The application of the chart description: medium:
water (20 °C).

It is recommended that the flow rate in pipes and valves should not exceed 5 m/s.

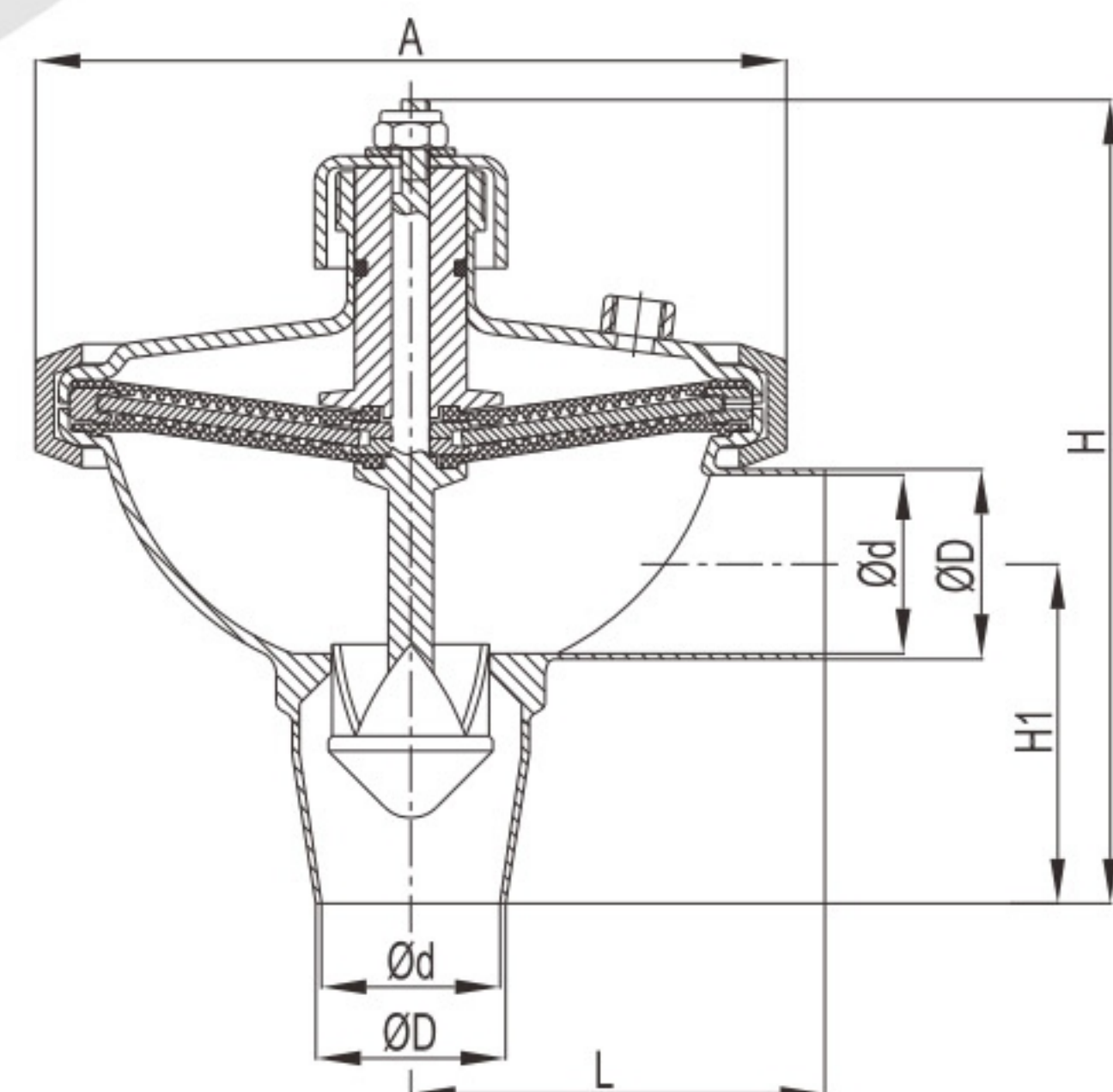
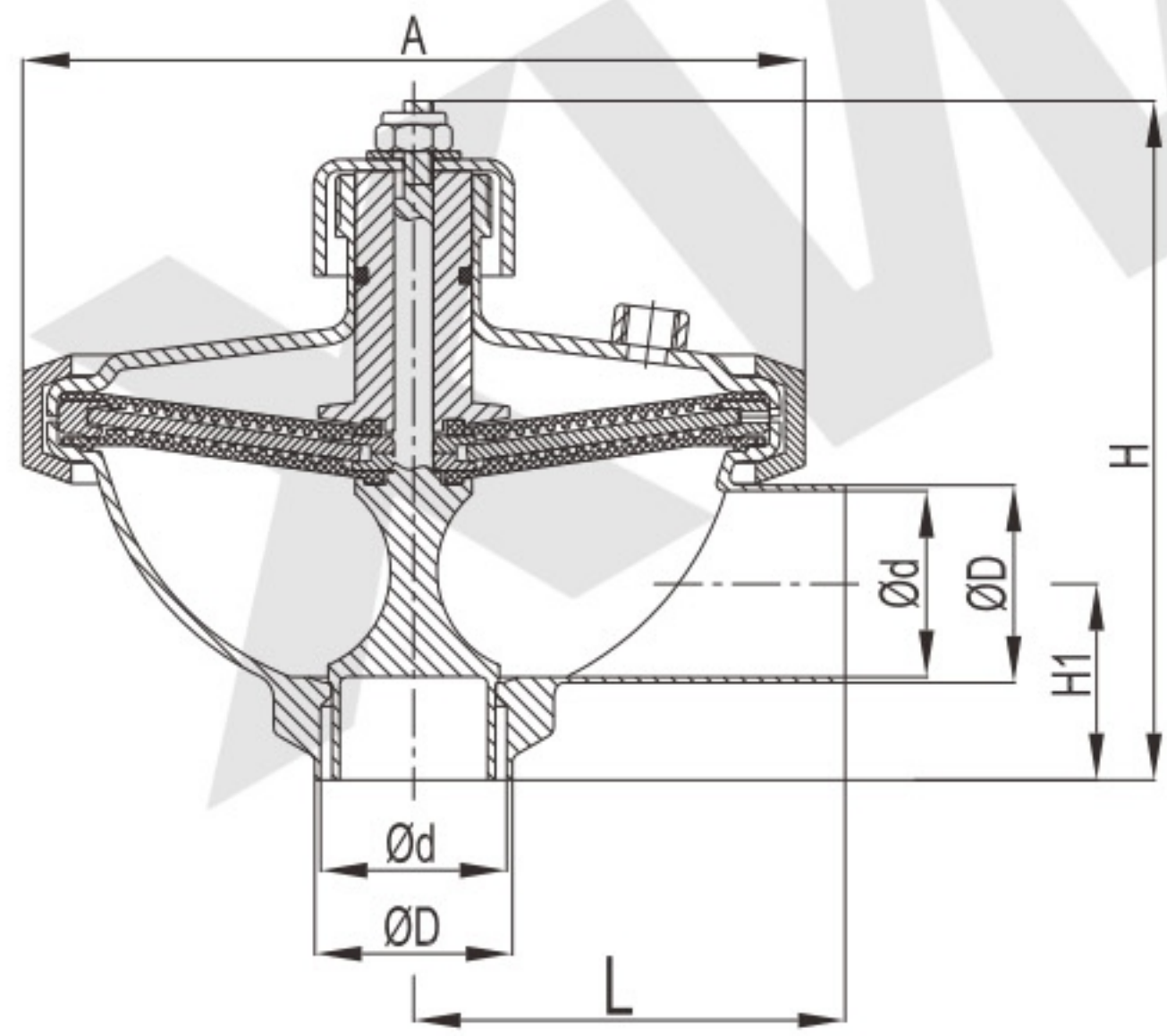
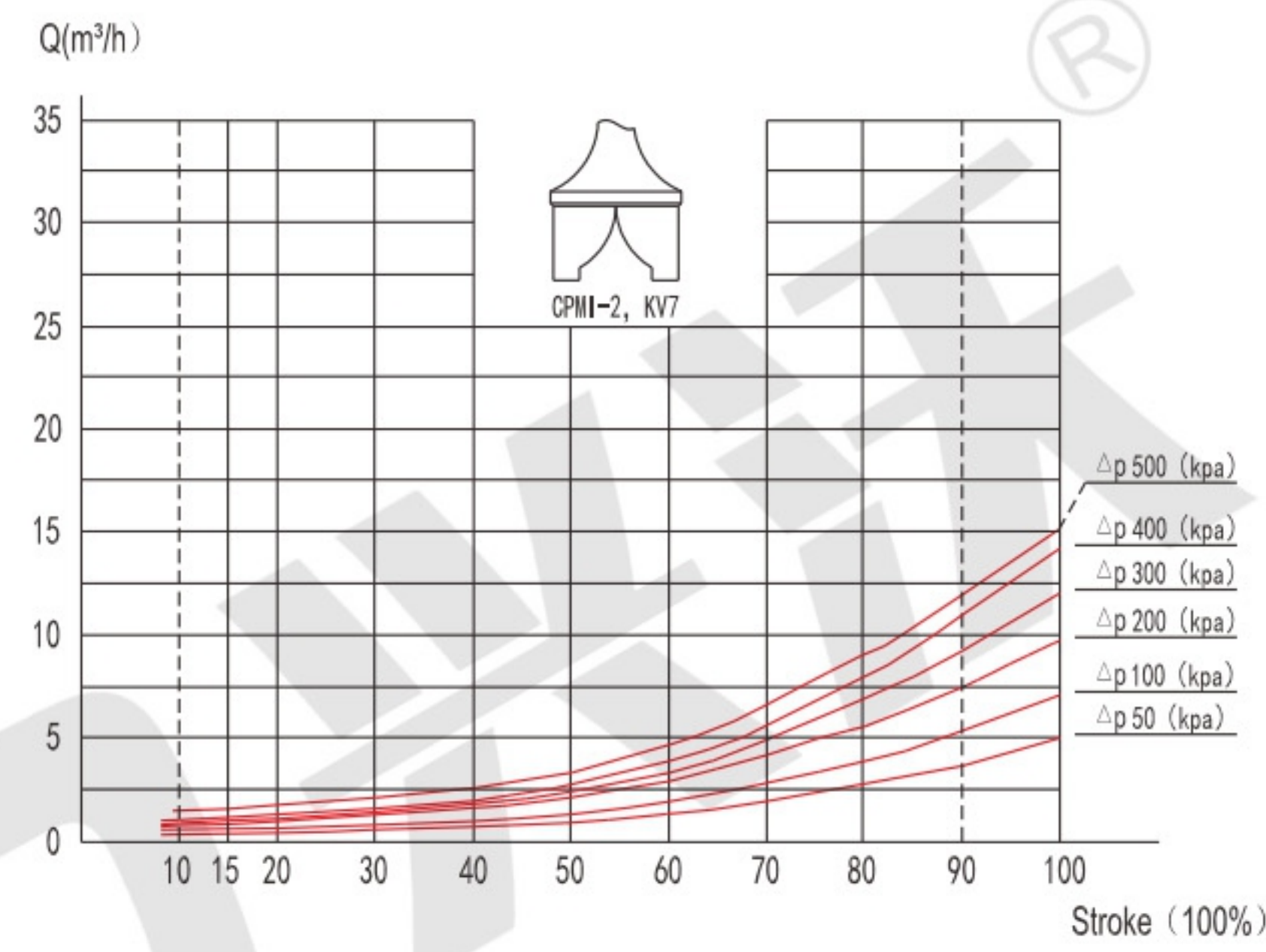
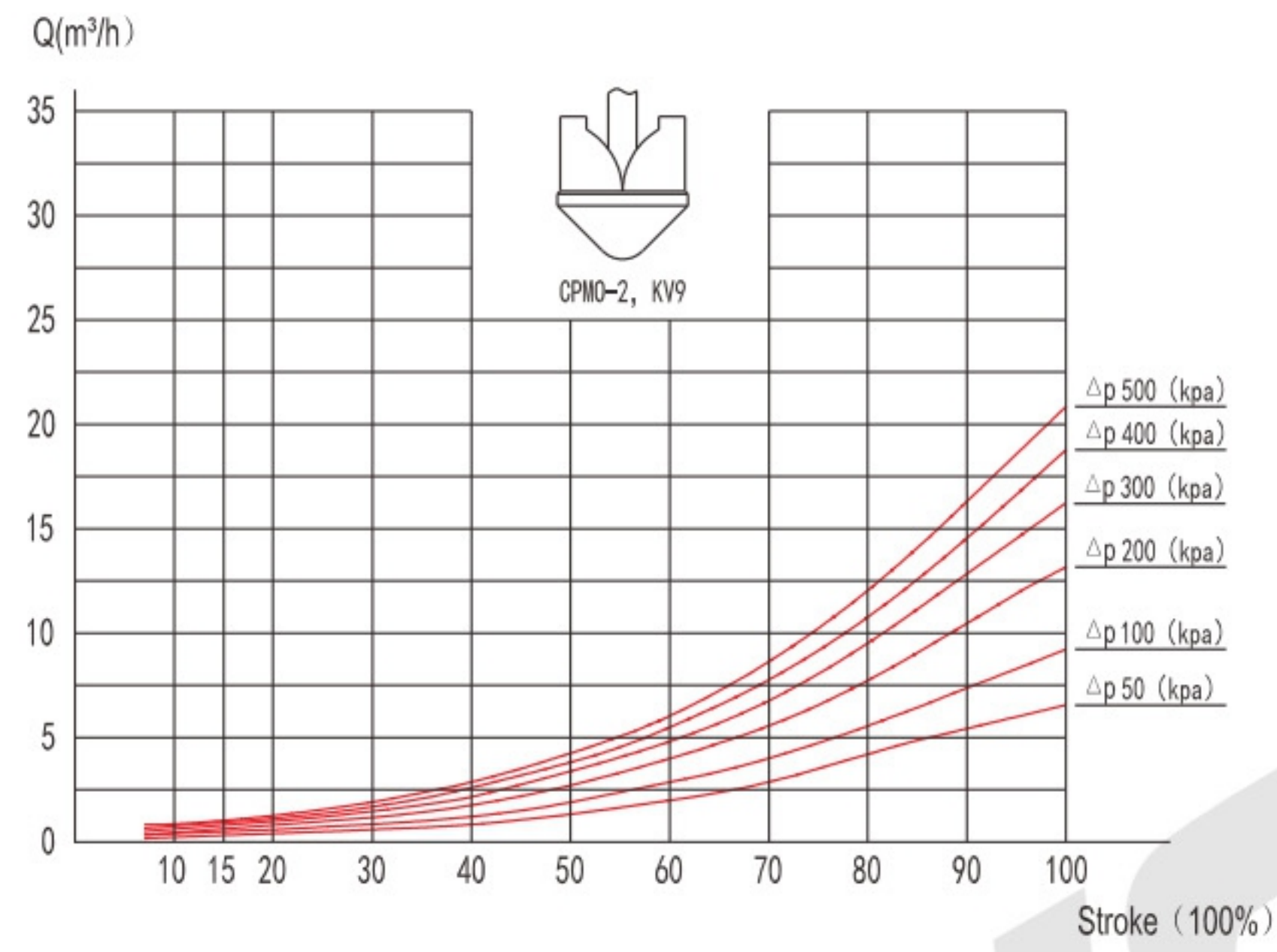
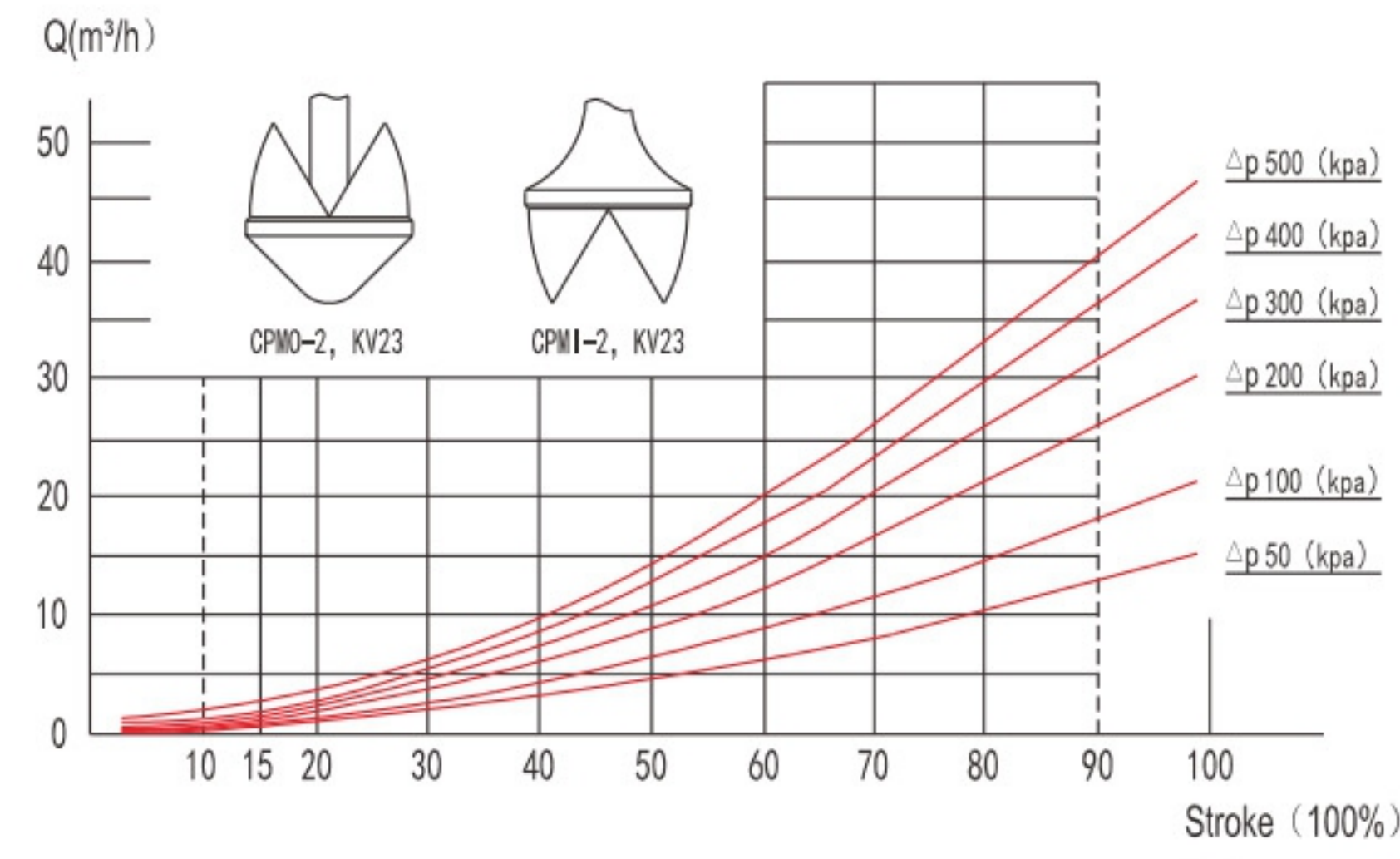

Size	d	D	A	L	H1	H
1.5"	35.1	38.1	203	110	44	175
2"	47.8	50.8	203	110	50	175

Size	d	D	A	L	H1	H
1.5"	35.1	38.1	203	110	84	215
2"	47.8	50.8	203	110	90	215

Size	d	D	A	L	H1	H
DN40	37	40	203	110	45	175
DN50	49	52	203	110	51	175

Size	d	D	A	L	H1	H
DN40	37	40	203	110	85	215
DN50	49	52	203	110	91	215